

# ILLUSTRATION BOOKLET

Part of 595-2172-02

## MAIN CIRCUIT BOARD PARTS PICTORIAL

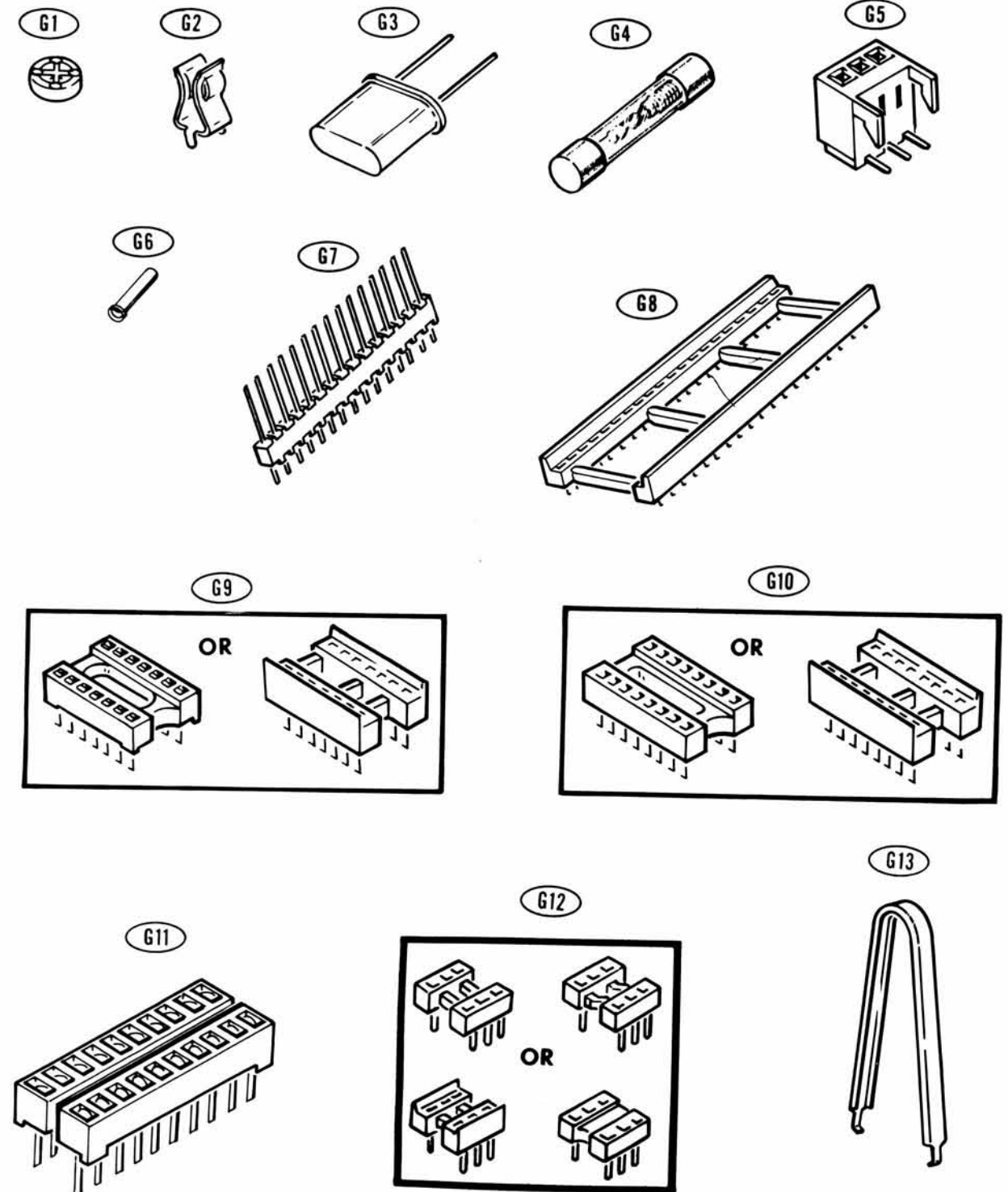
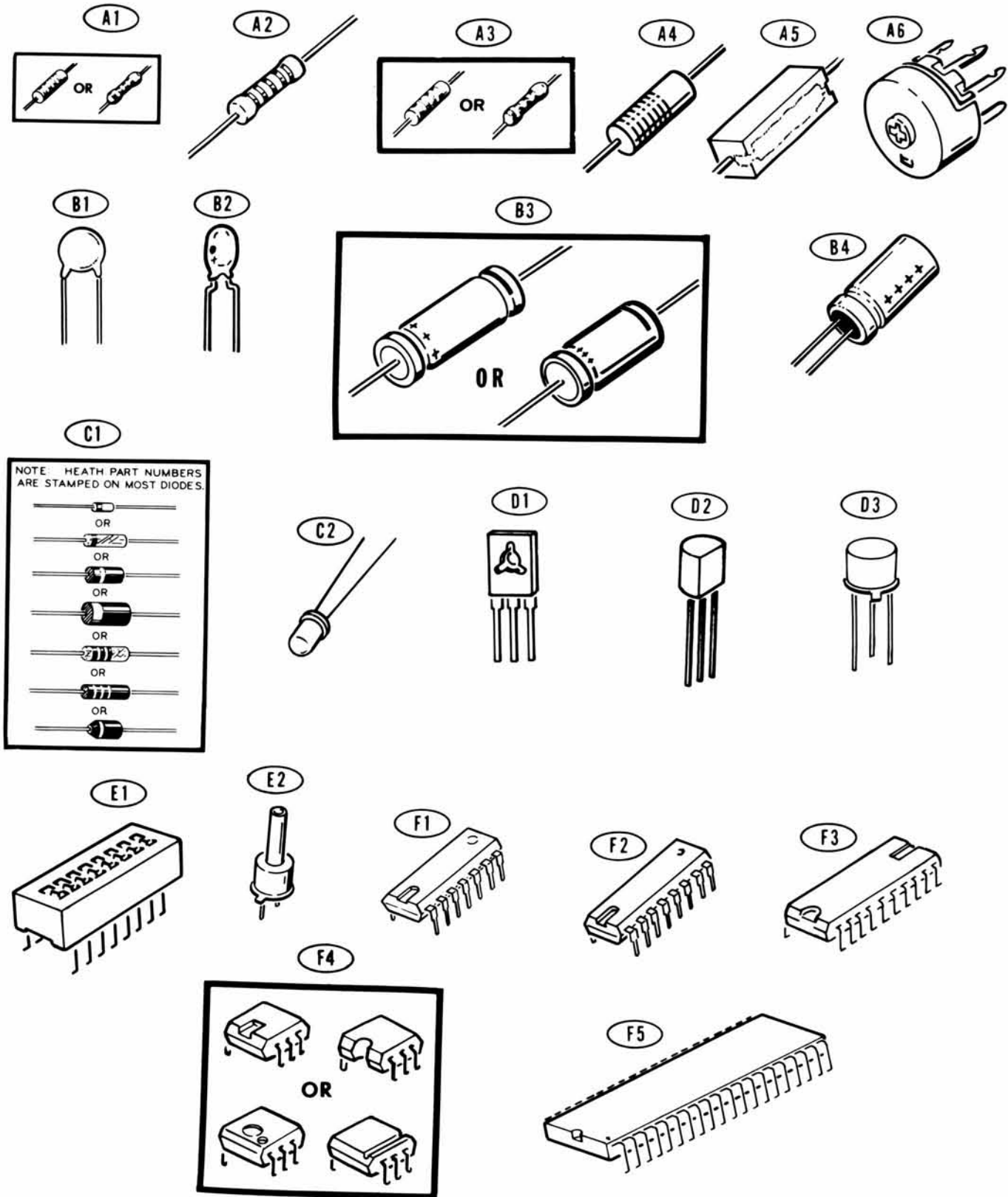

Model H14 Assembly

Copyright © 1979  
Heath Company  
All Rights Reserved  
Printed in the United States of America

# STEPPER DRIVER CIRCUIT BOARD PARTS PICTORIAL

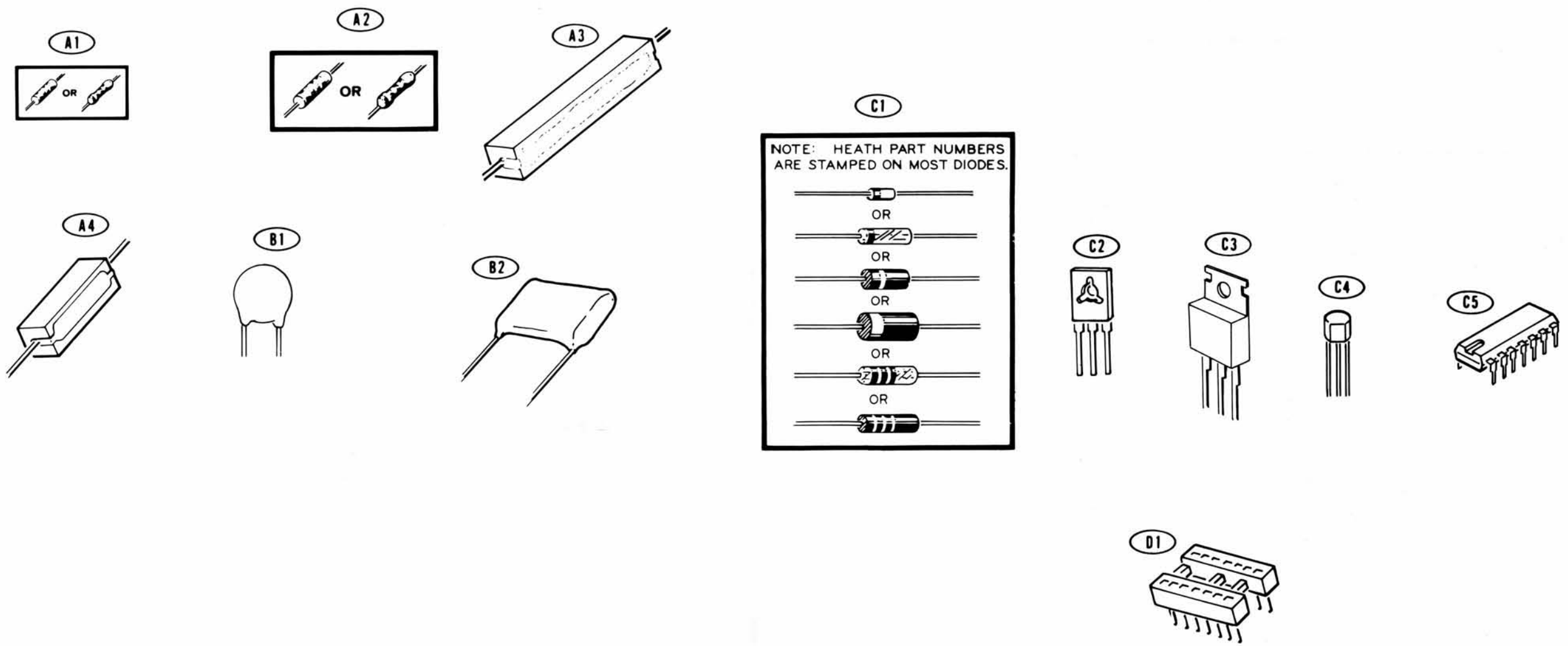

# CHASSIS PARTS PICTORIAL

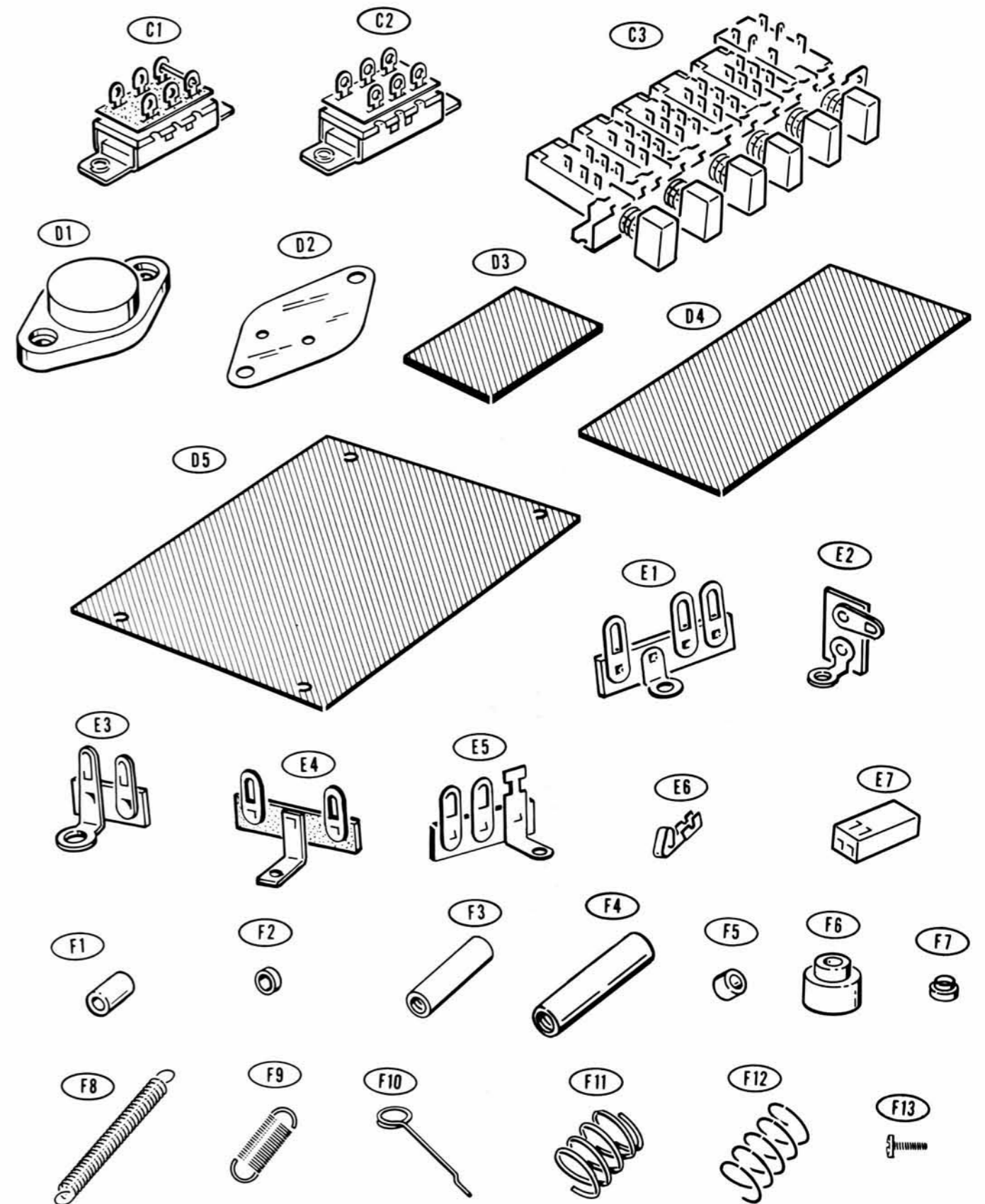
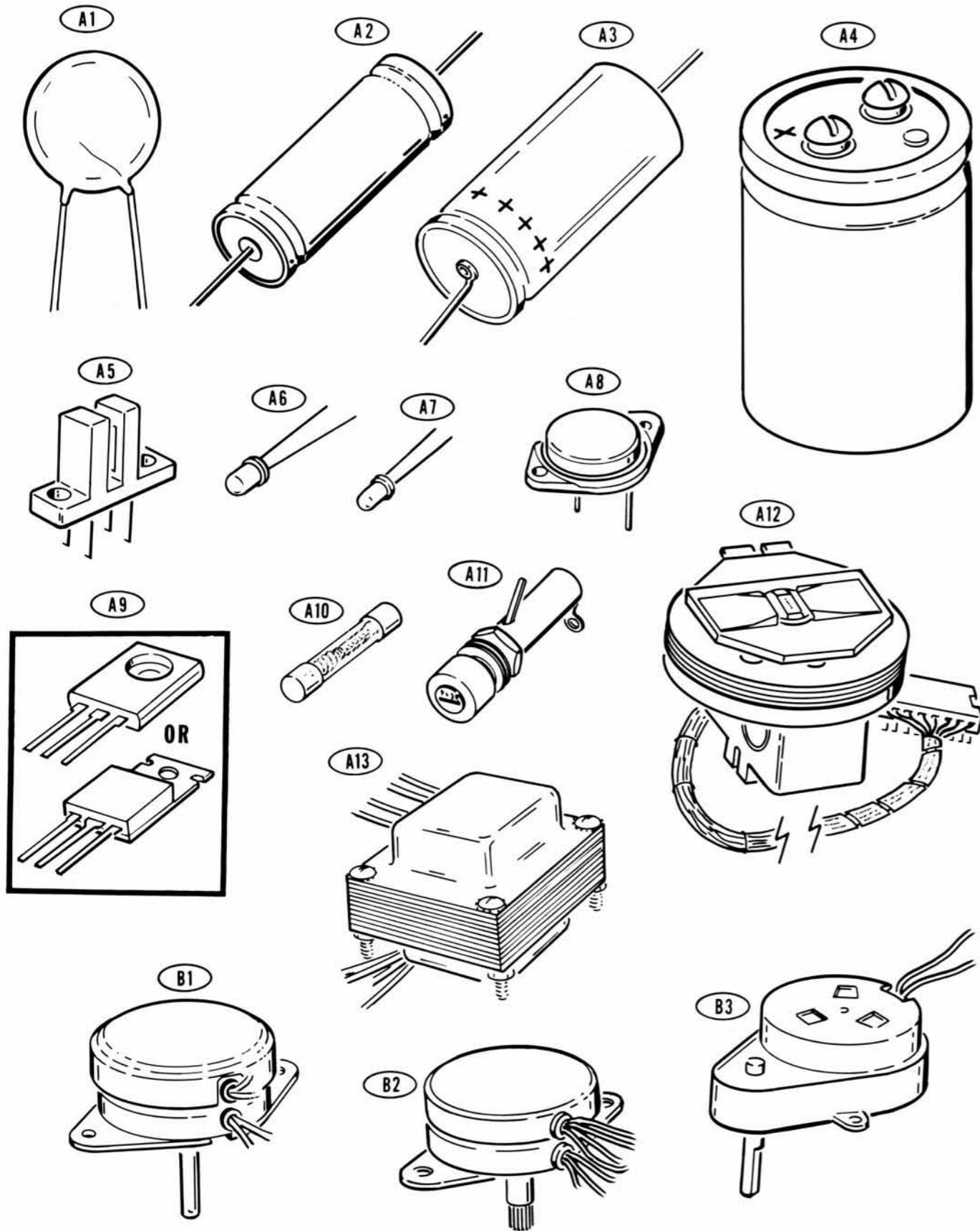

### Chassis Parts Pictorial (cont'd.)

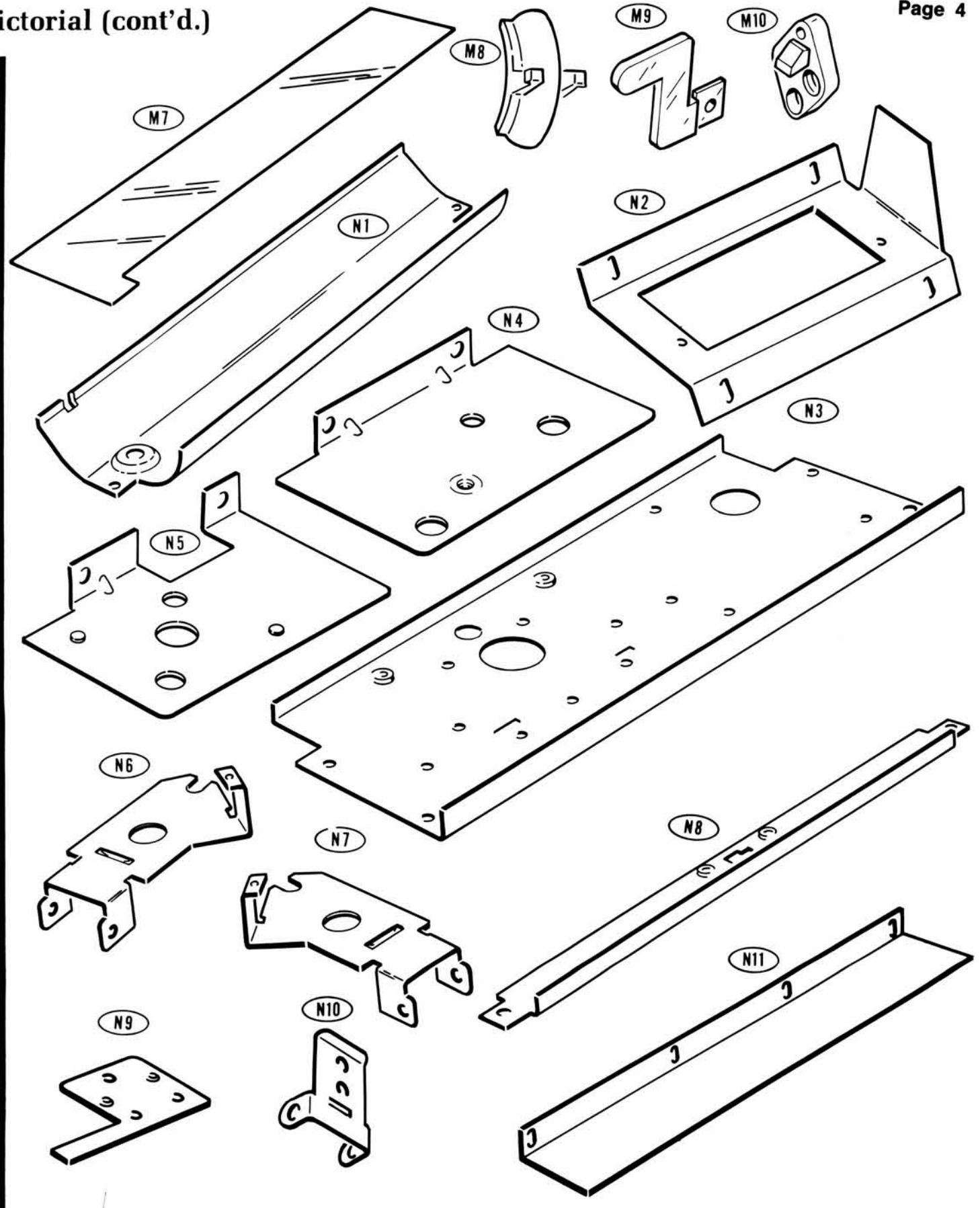
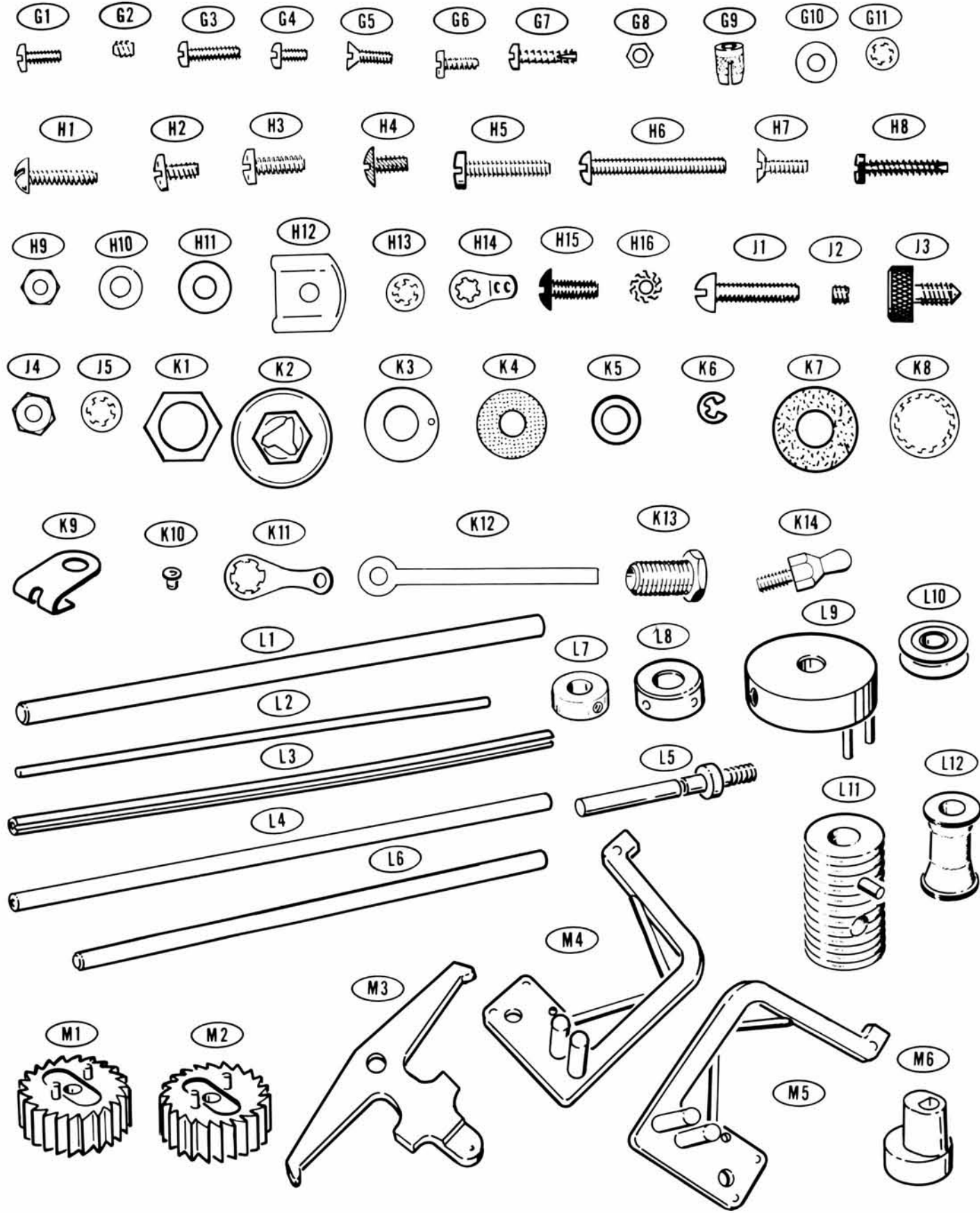

# Chassis Parts Pictorial (cont'd.)

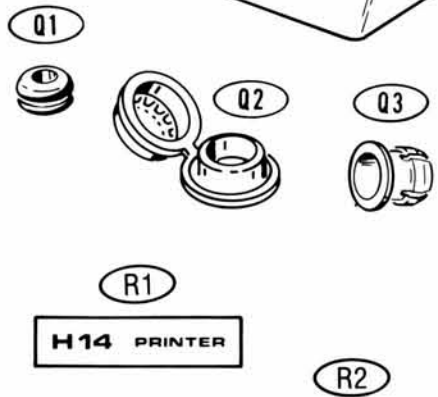
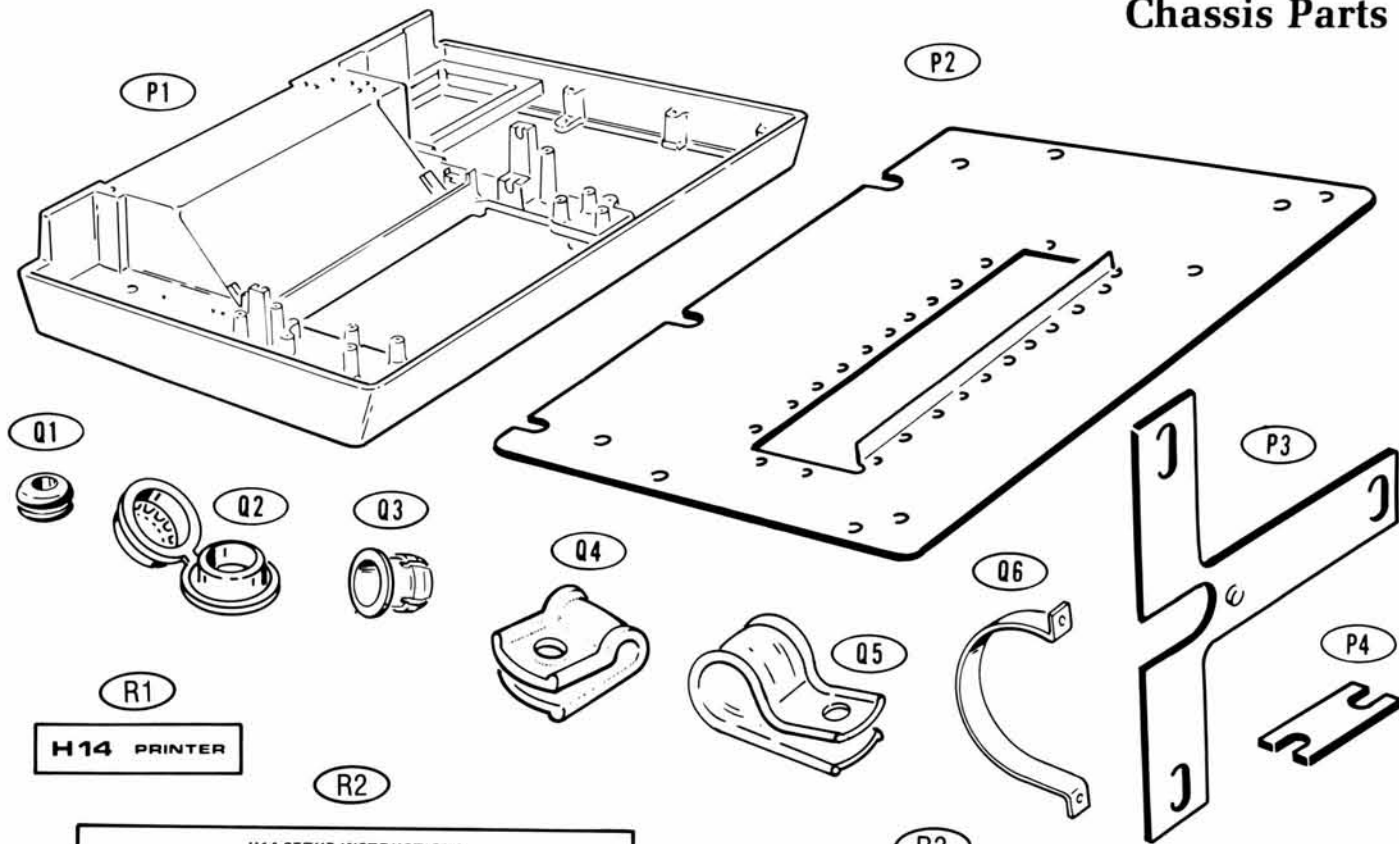

**H14 PRINTER**

H14 SETUP INSTRUCTIONS	
<b>I/O JUMPERS</b>	<b>SW 102</b>
input RS232, J114 to J115	<input type="checkbox"/> 7 <input type="checkbox"/> 6 <input type="checkbox"/> 5 <input type="checkbox"/> 4 <input type="checkbox"/> 3 <input type="checkbox"/> 2 <input type="checkbox"/> 1 <input type="checkbox"/> 0
input 20mA, J113 to J114	
output RS232, J109 to J110	
output 20mA, J110 to J111	
<b>20mA LOOP</b>	<b>BAUD RATES</b>
input passive, J101 to J102	switch sections 7 6 5
input active, J102 to J104	BAUD RATE
J101 to J103	110..... 1 1 1
output passive, J105 to J106	150..... 1 1 0
output active, J105 to J107	300..... 1 0 1
J106 to J108	600..... 1 0 0
	1200..... 0 1 1
	2400..... 0 1 0
	4800..... 0 0 1
	9600..... 0 0 0
<b>HI TEMP CAL JUMPER</b>	<b>POWER LINE FREQ.</b>
operate J118 to J119	for 60Hz sw section 2=(1)
calibrate J117 to J118	for 50Hz sw section 2=(0)
SEE MANUAL FOR CALIBRATION INSTRUCTIONS	<b>AUTO LINE FEED</b>
	for auto sw section 3=(0)
	for norm sw section 3=(1)
	<b>TEST</b>
	to operate sw section 4=(1)
	to test sw section 4=(0)

390-1472

**EIA-416**  
120 / 240 VAC 50 / 60 Hz 100 WATTS

**CAUTION: TO PREVENT ELECTRICAL SHOCK HAZARD, DISCONNECT LINE CORD BEFORE REMOVING COVERS. FOR CONTINUED PROTECTION AGAINST FIRE HAZARD, REPLACE FUSE ONLY WITH SAME TYPE AND RATING.**  
120V 1 AMP SLOW BLOW 240V 1/2 AMP SLOW BLOW

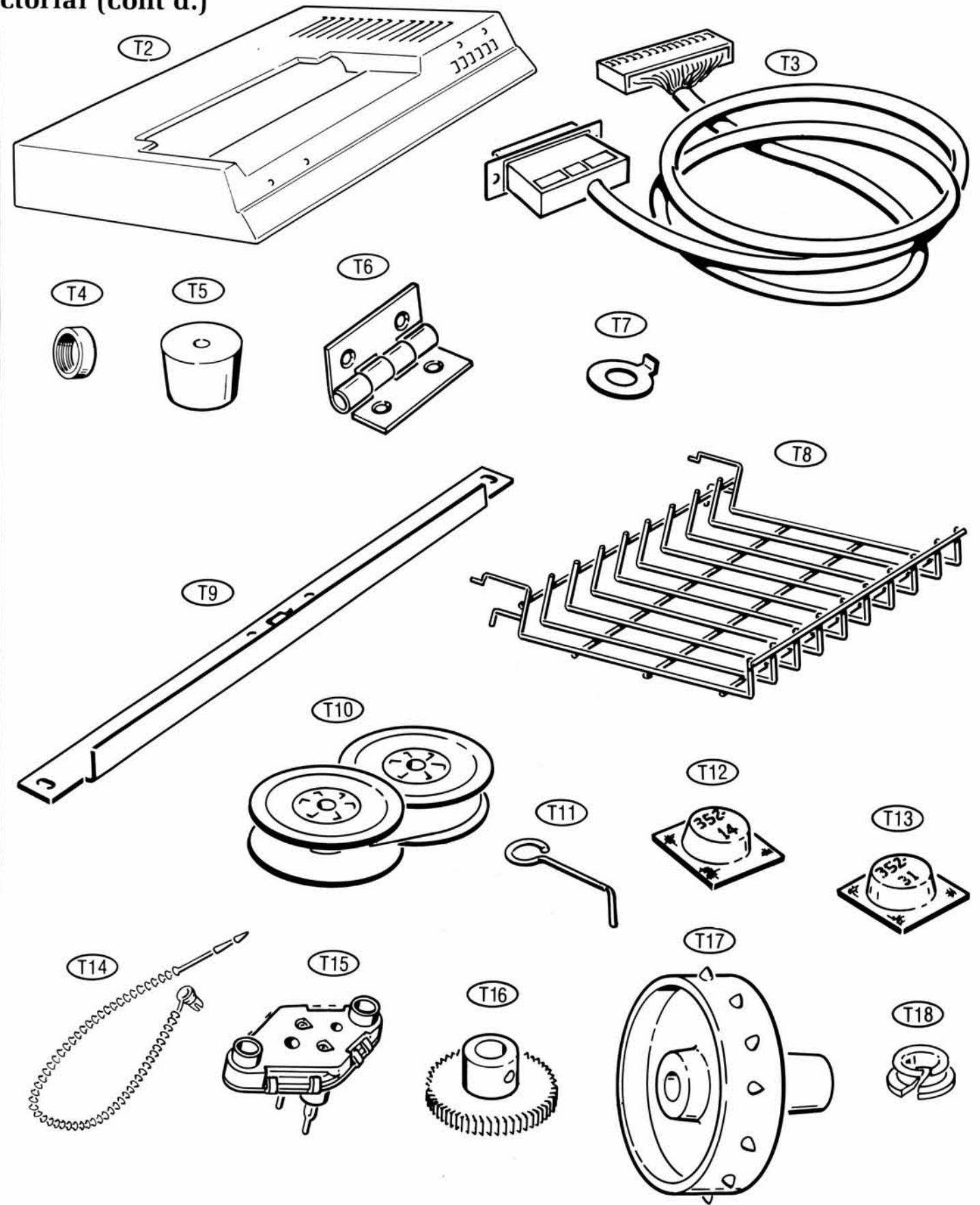
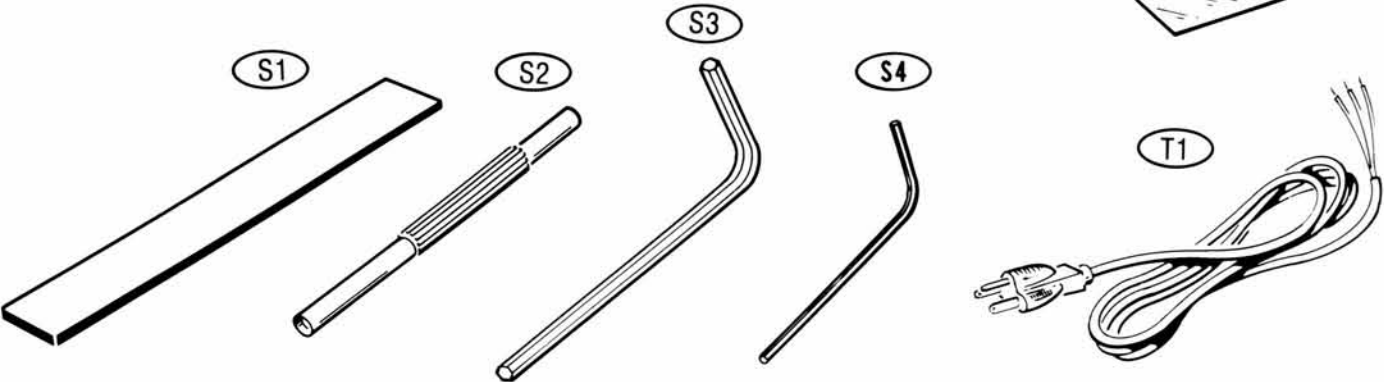
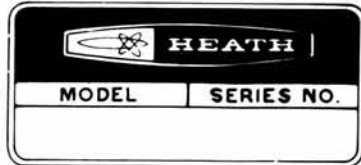

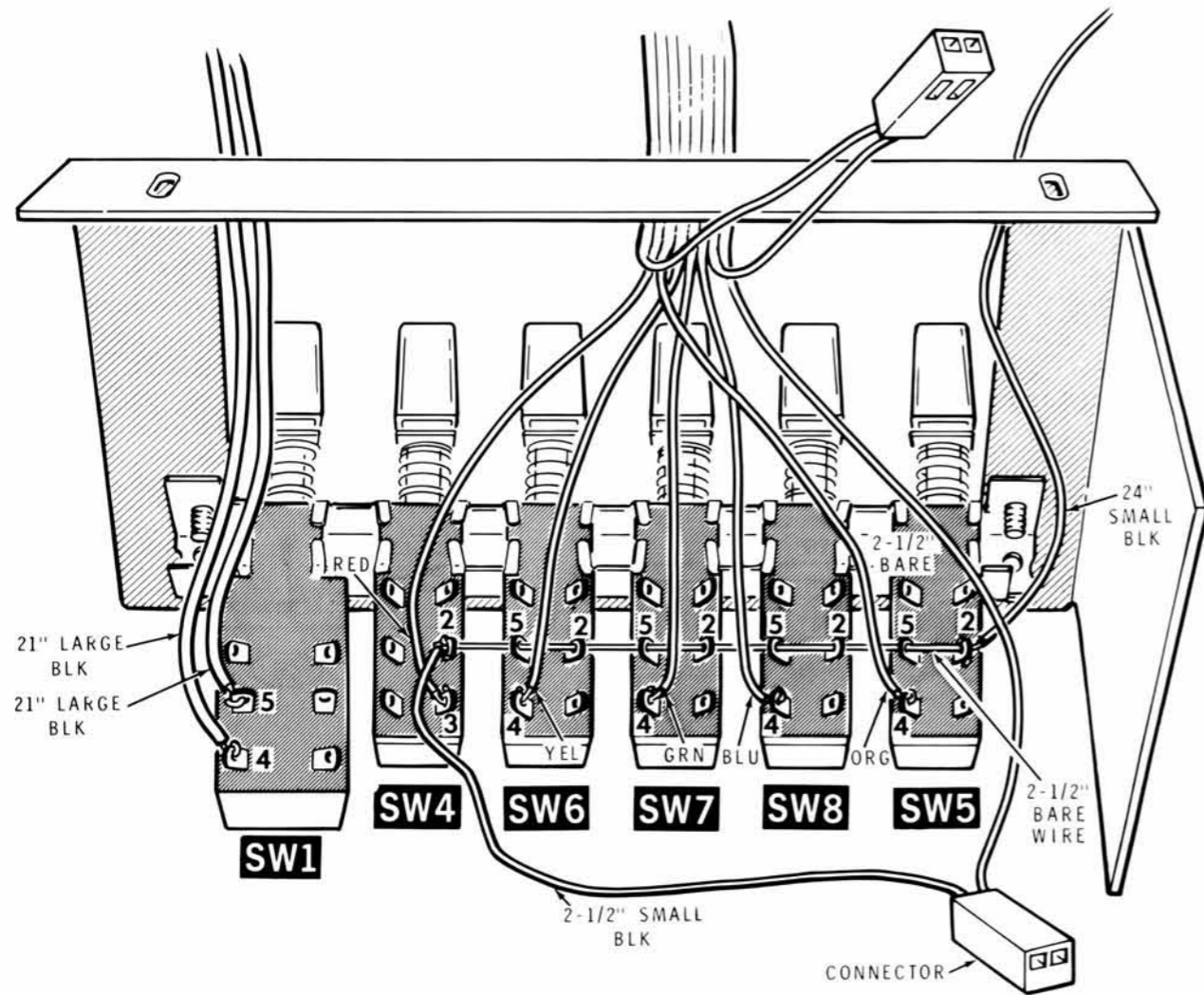

PICTORIAL 3-1

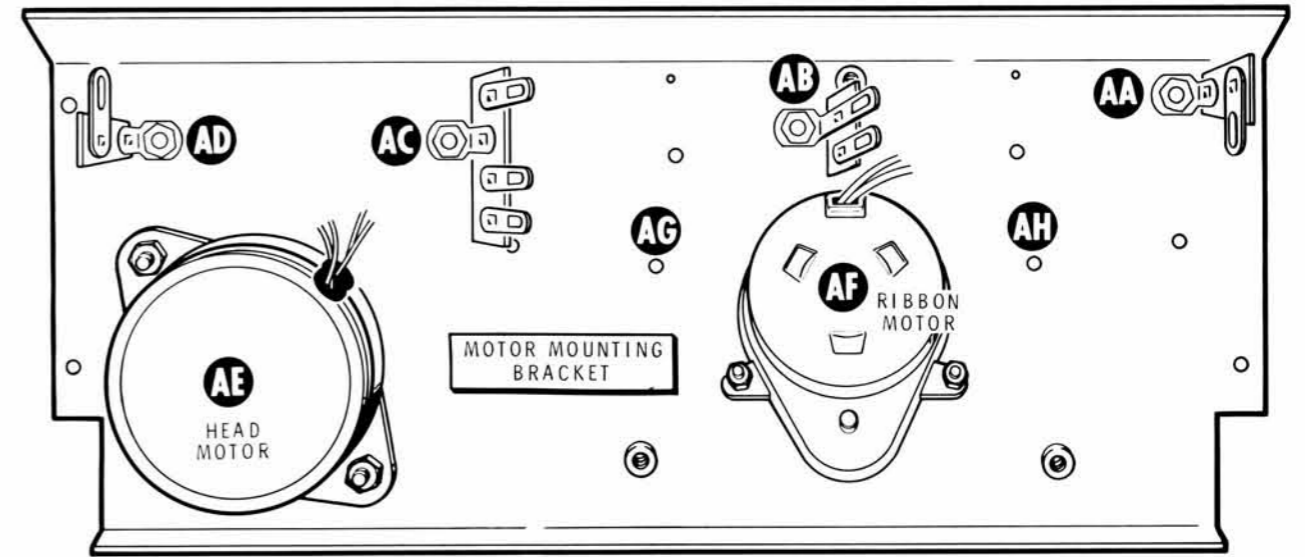

PICTORIAL 3-2

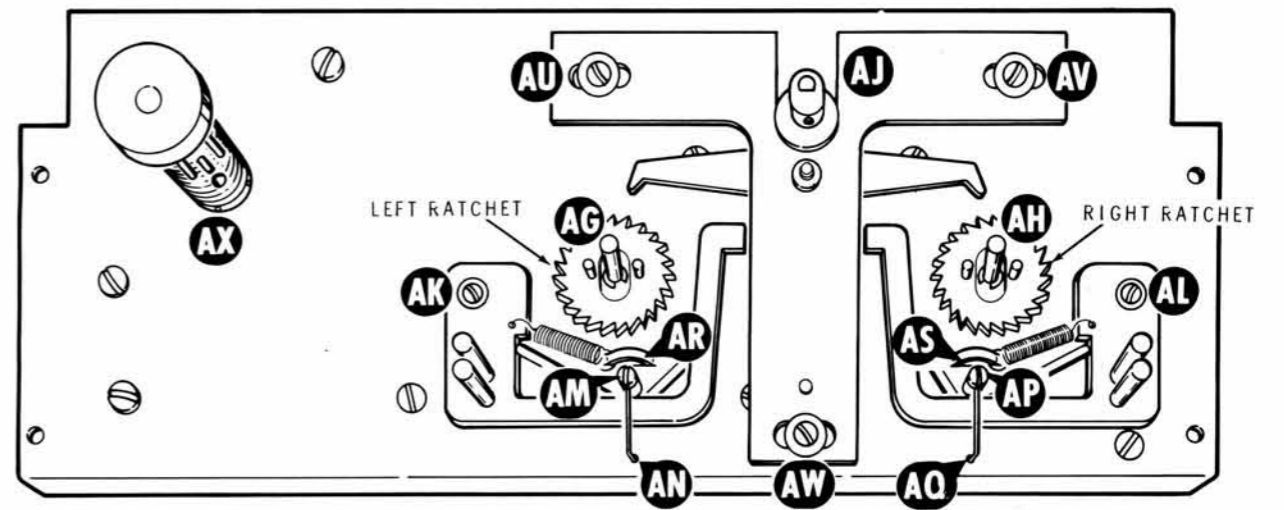

PICTORIAL 3-3

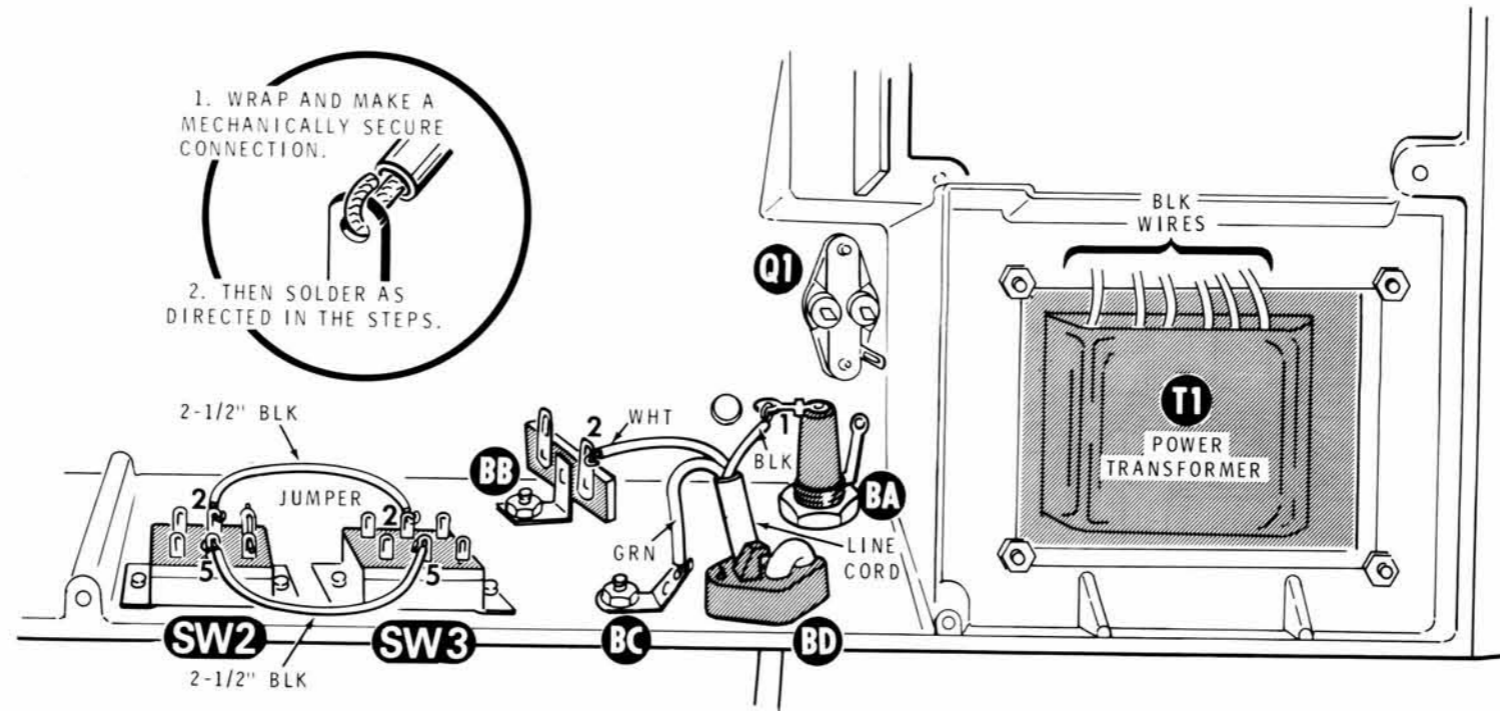

PICTORIAL 4-1

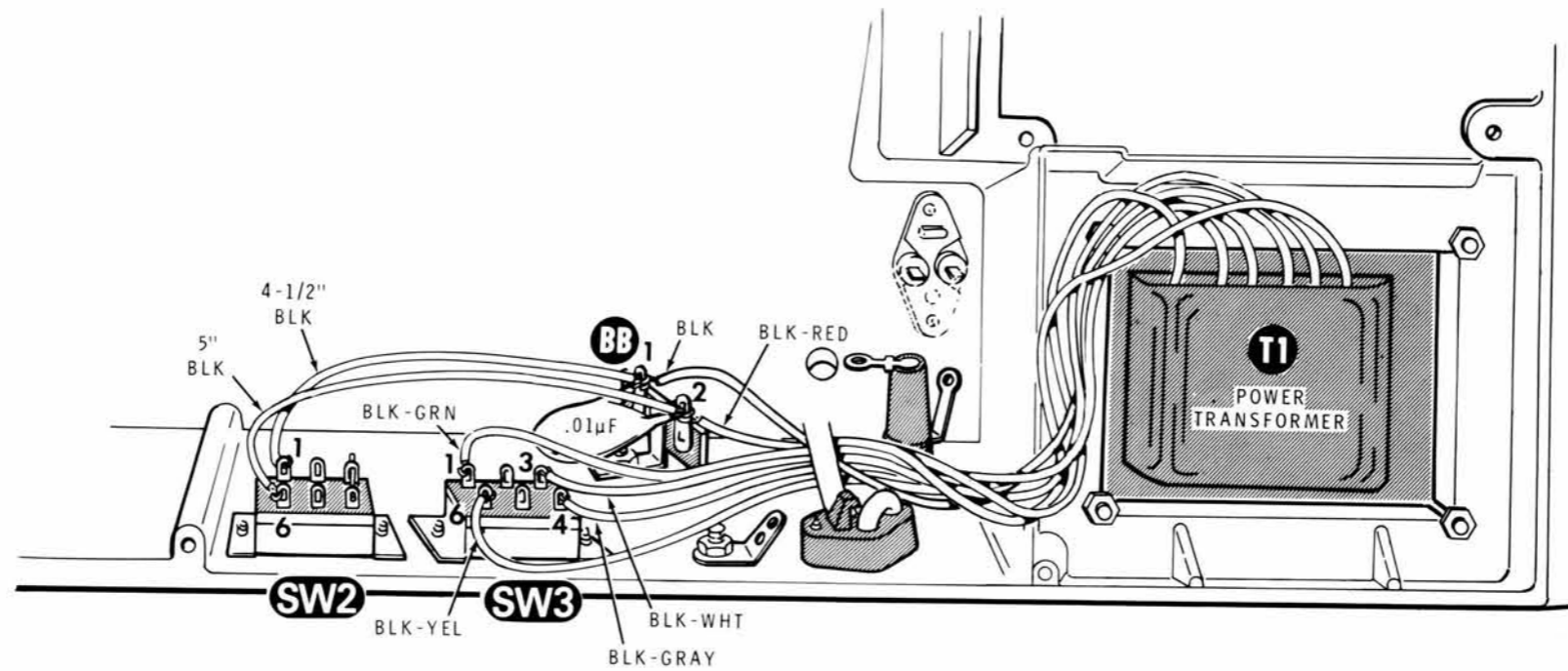

PICTORIAL 4-2

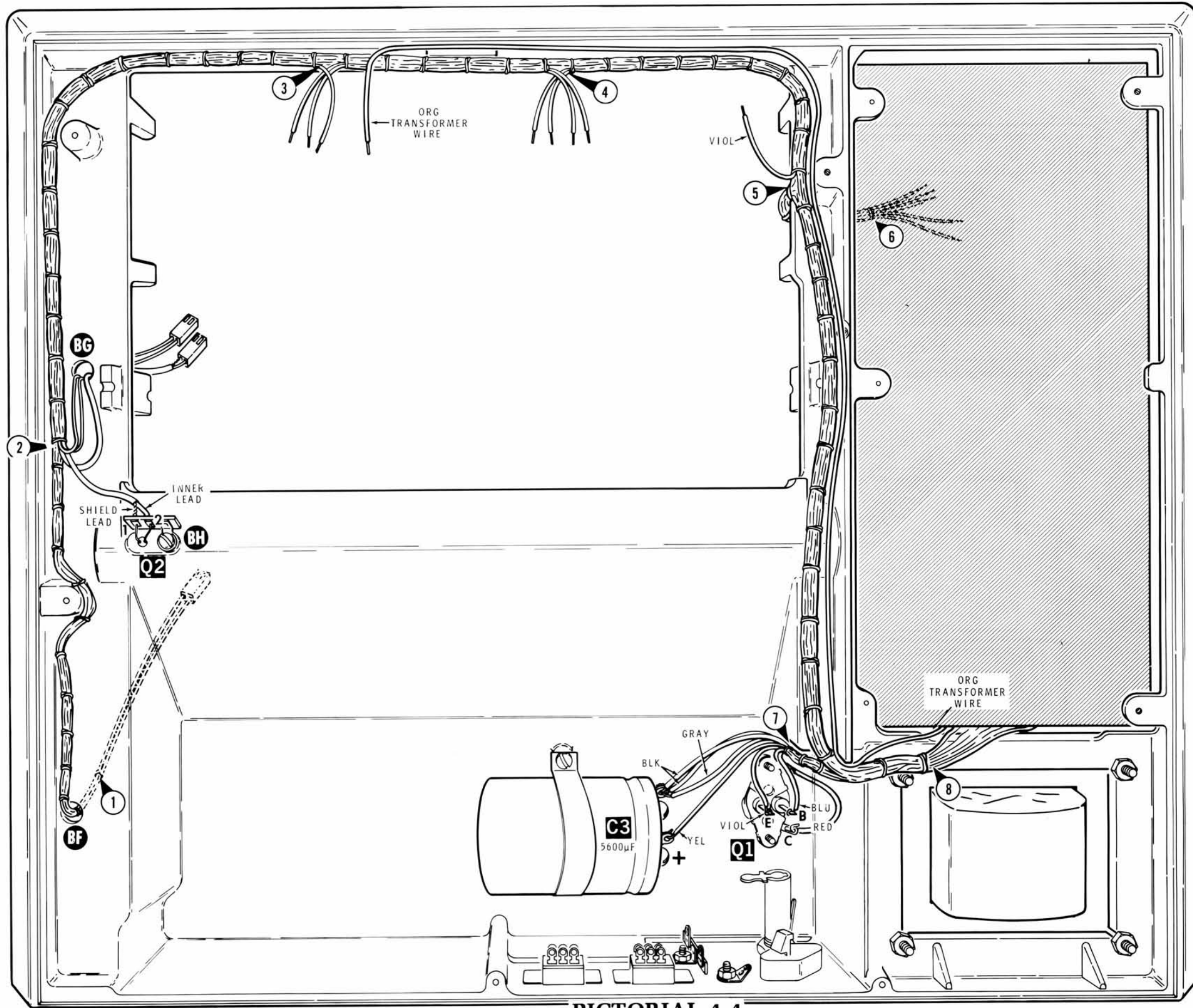

PICTORIAL 4-4



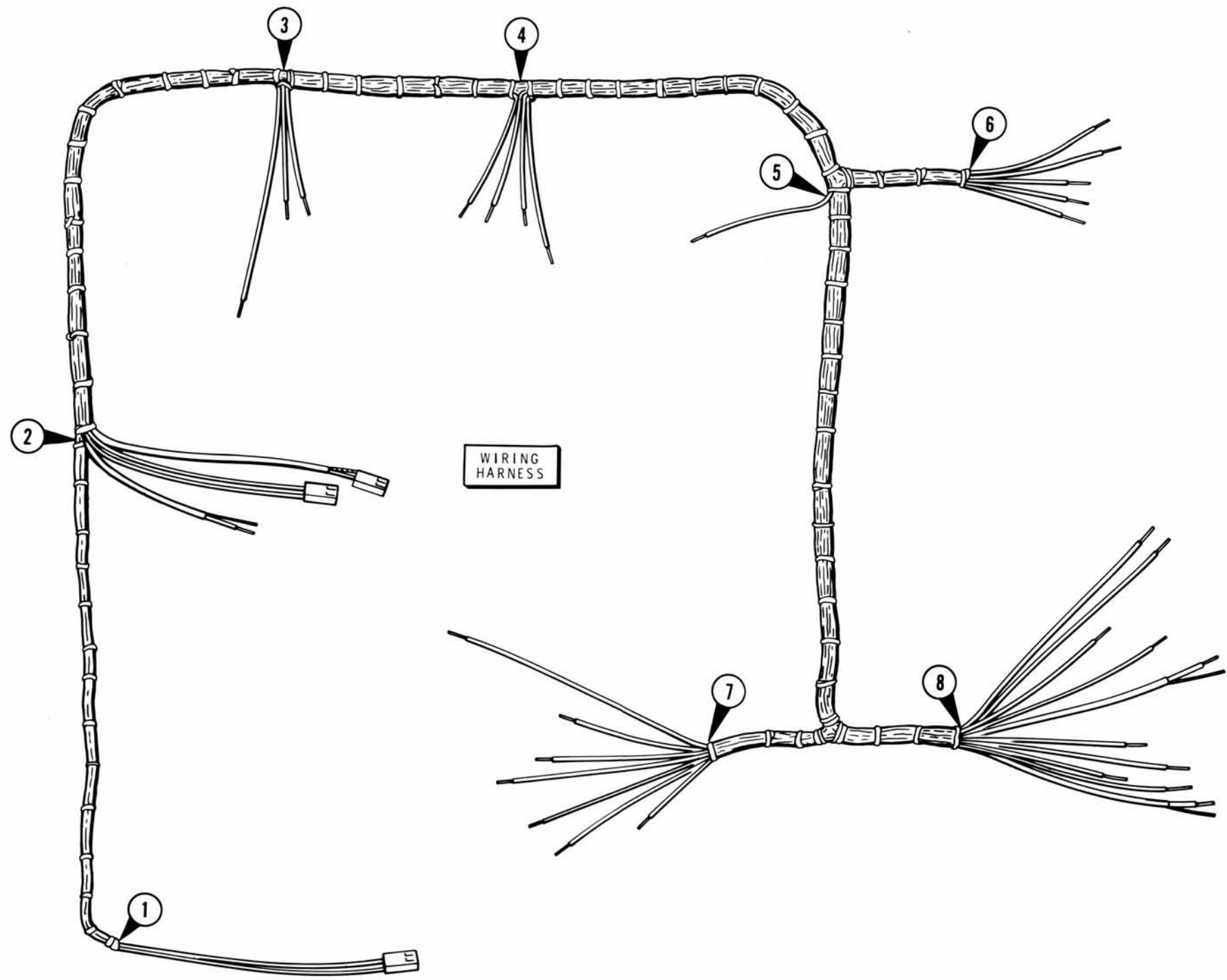

Detail 4-4A

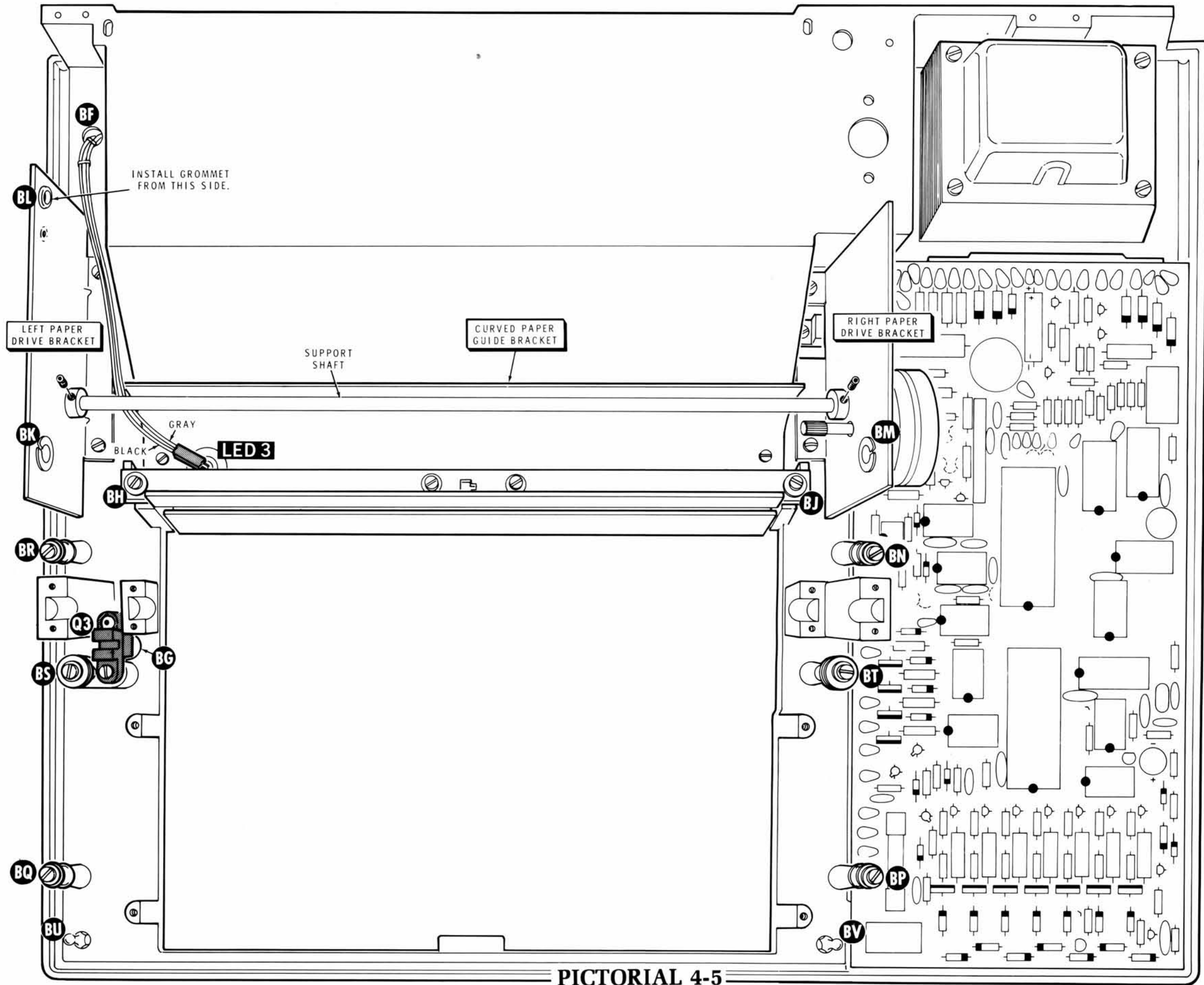

PICTORIAL 4-5

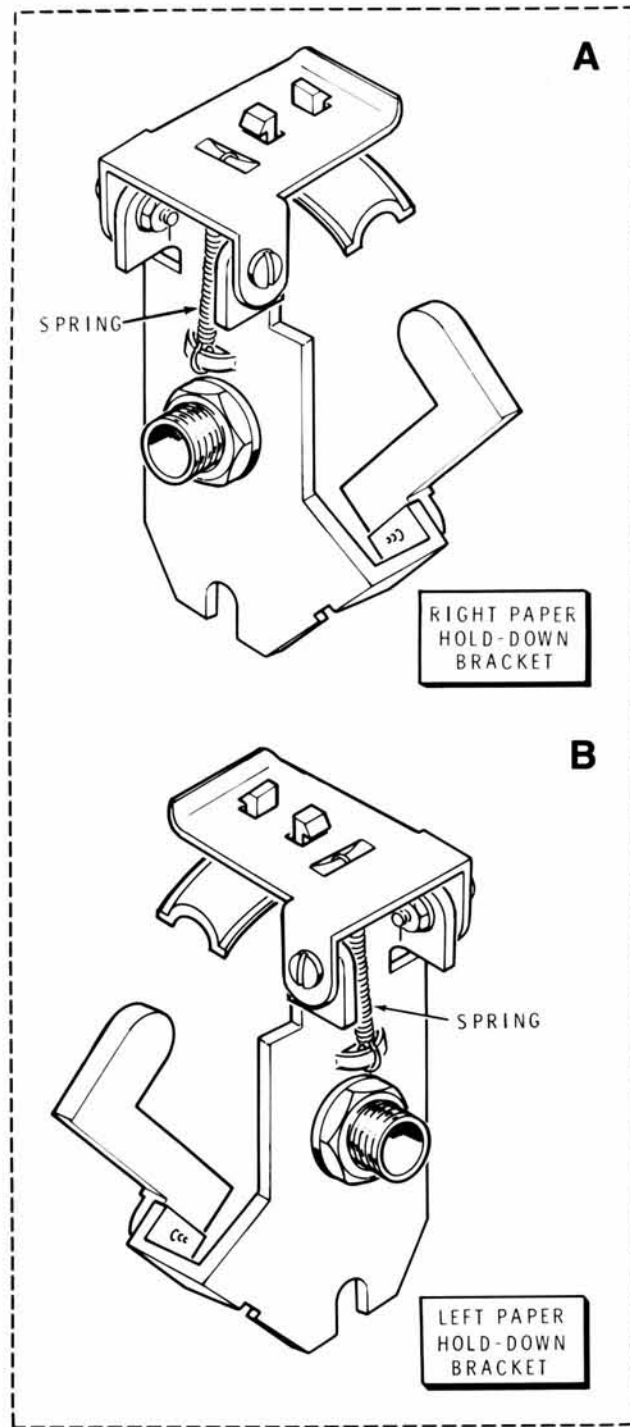

**PICTORIAL 4-6**

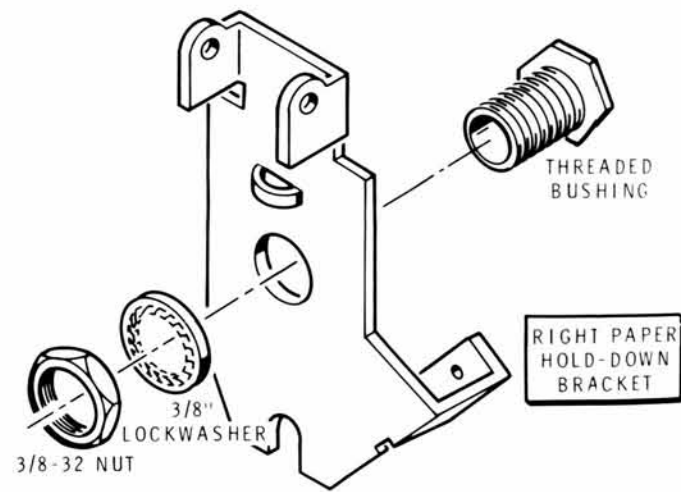

**Detail 4-6A**

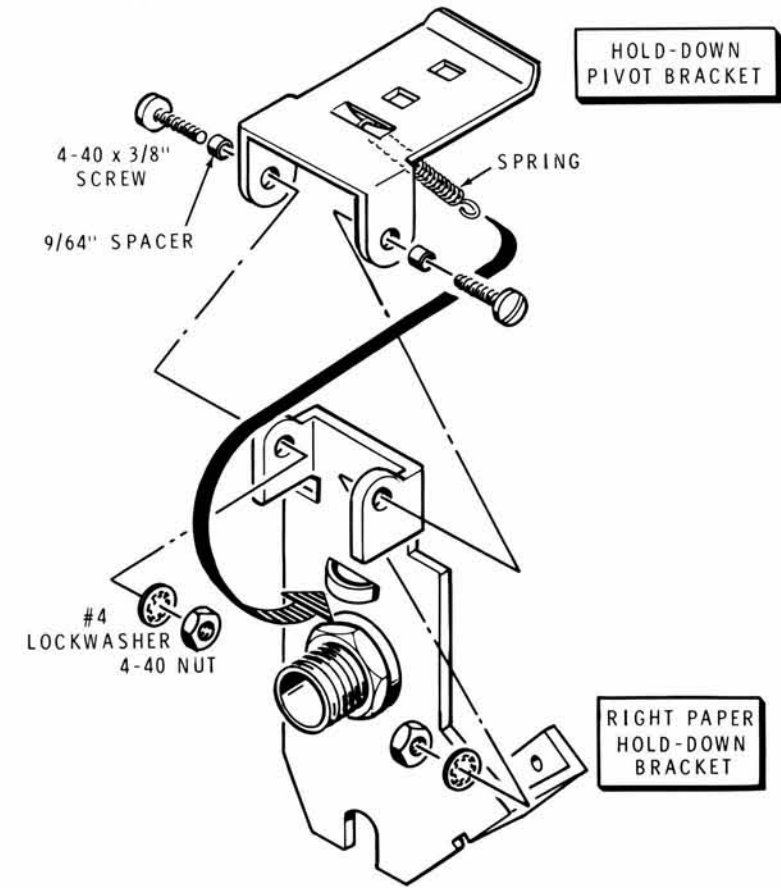

**Detail 4-6B**

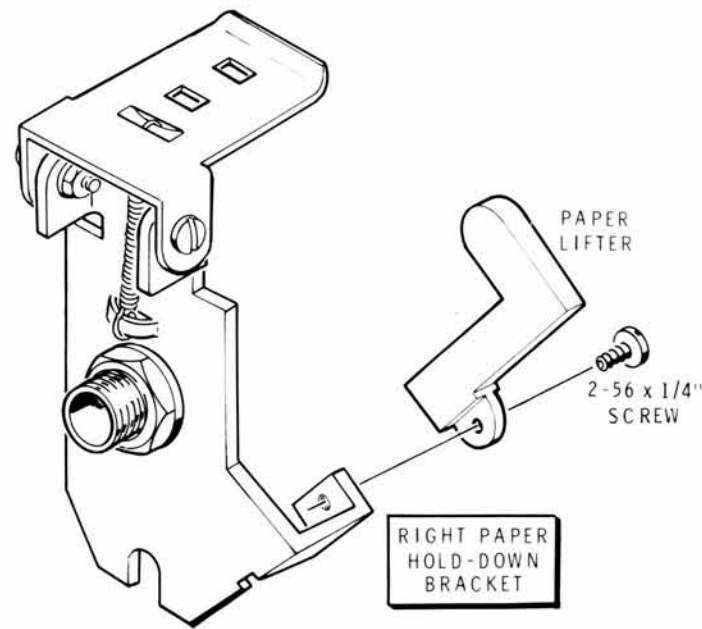

**Detail 4-6C**

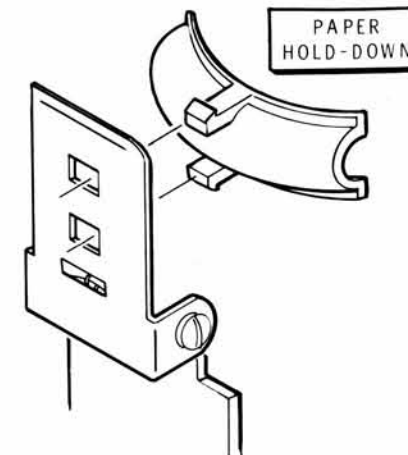

**Detail 4-6D**

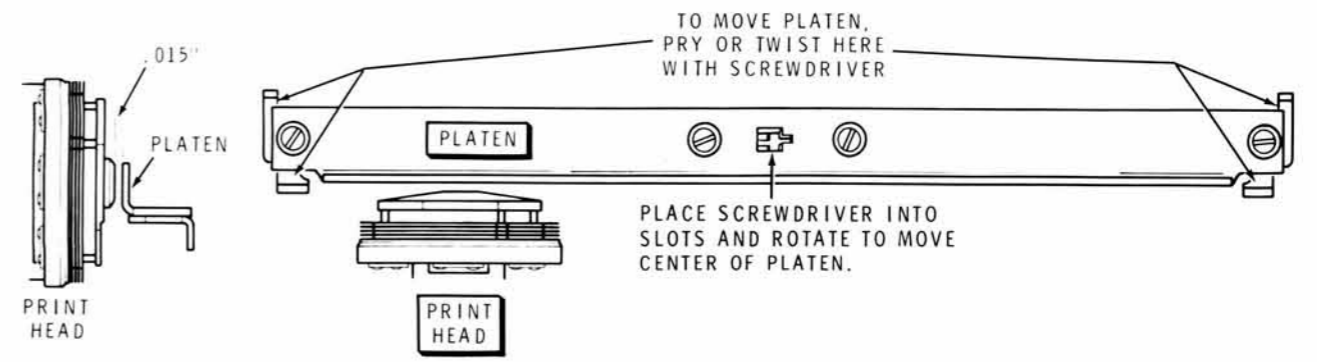
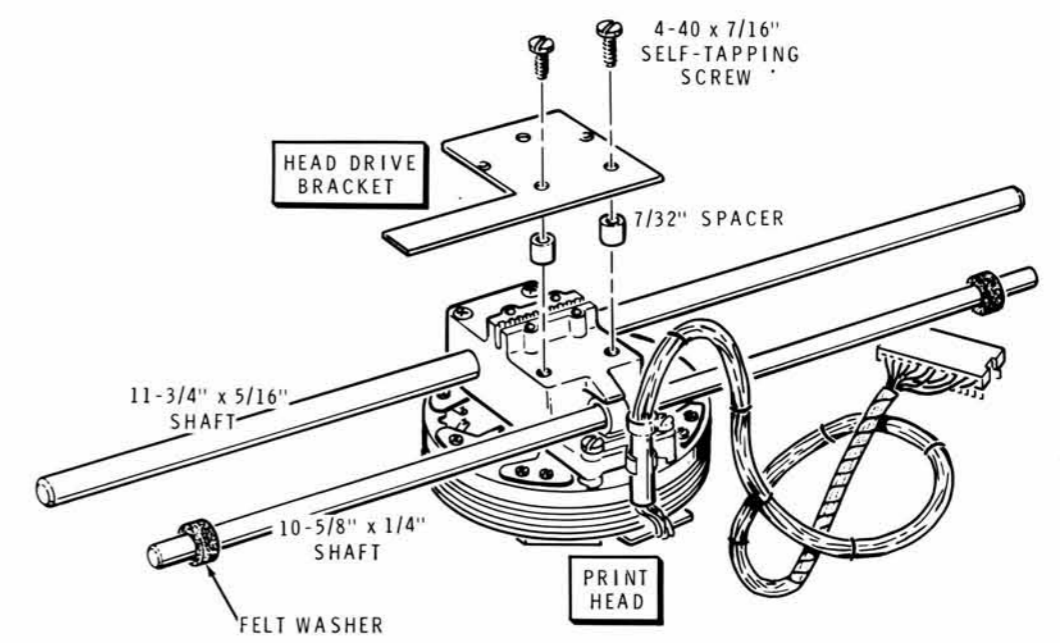
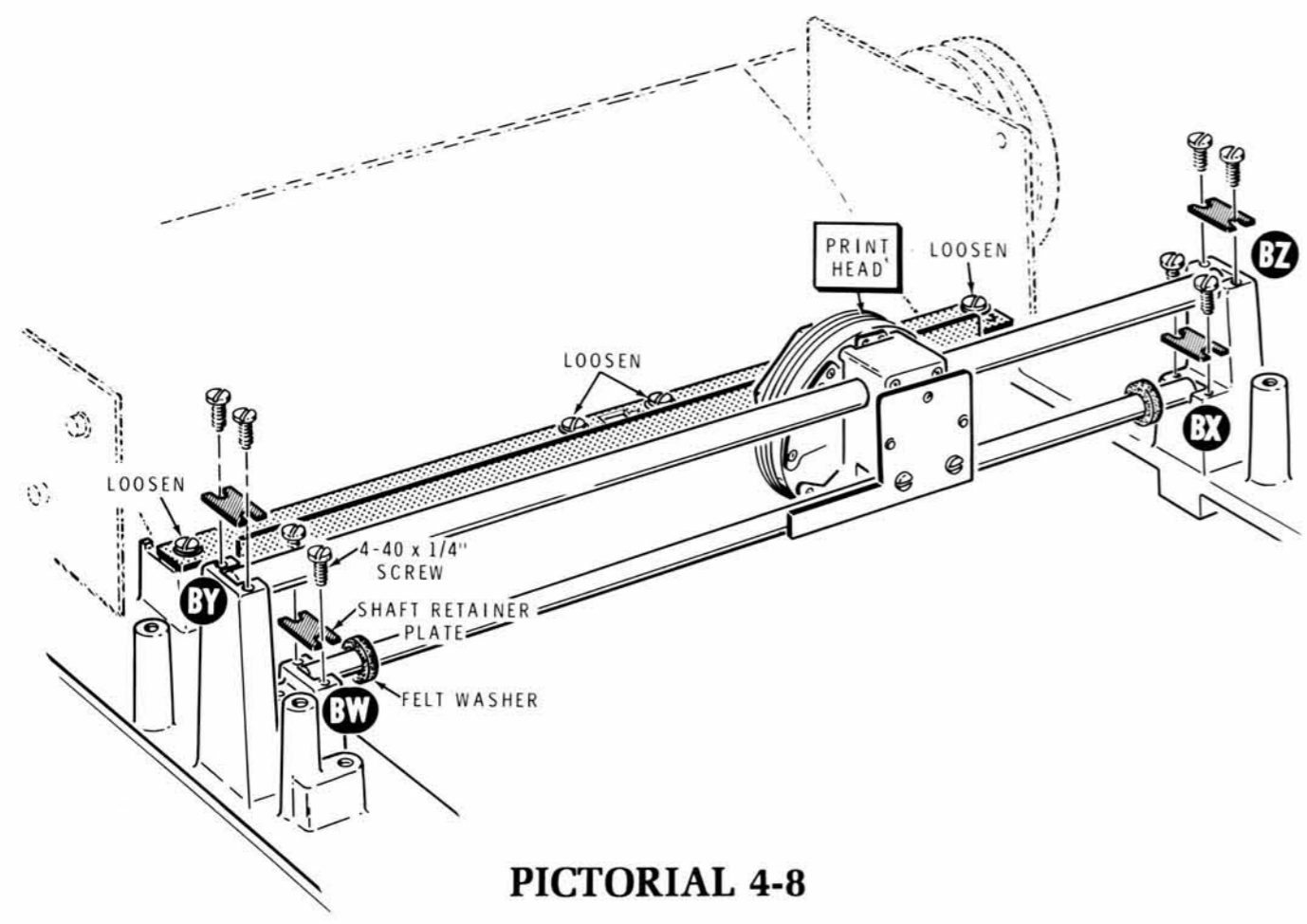

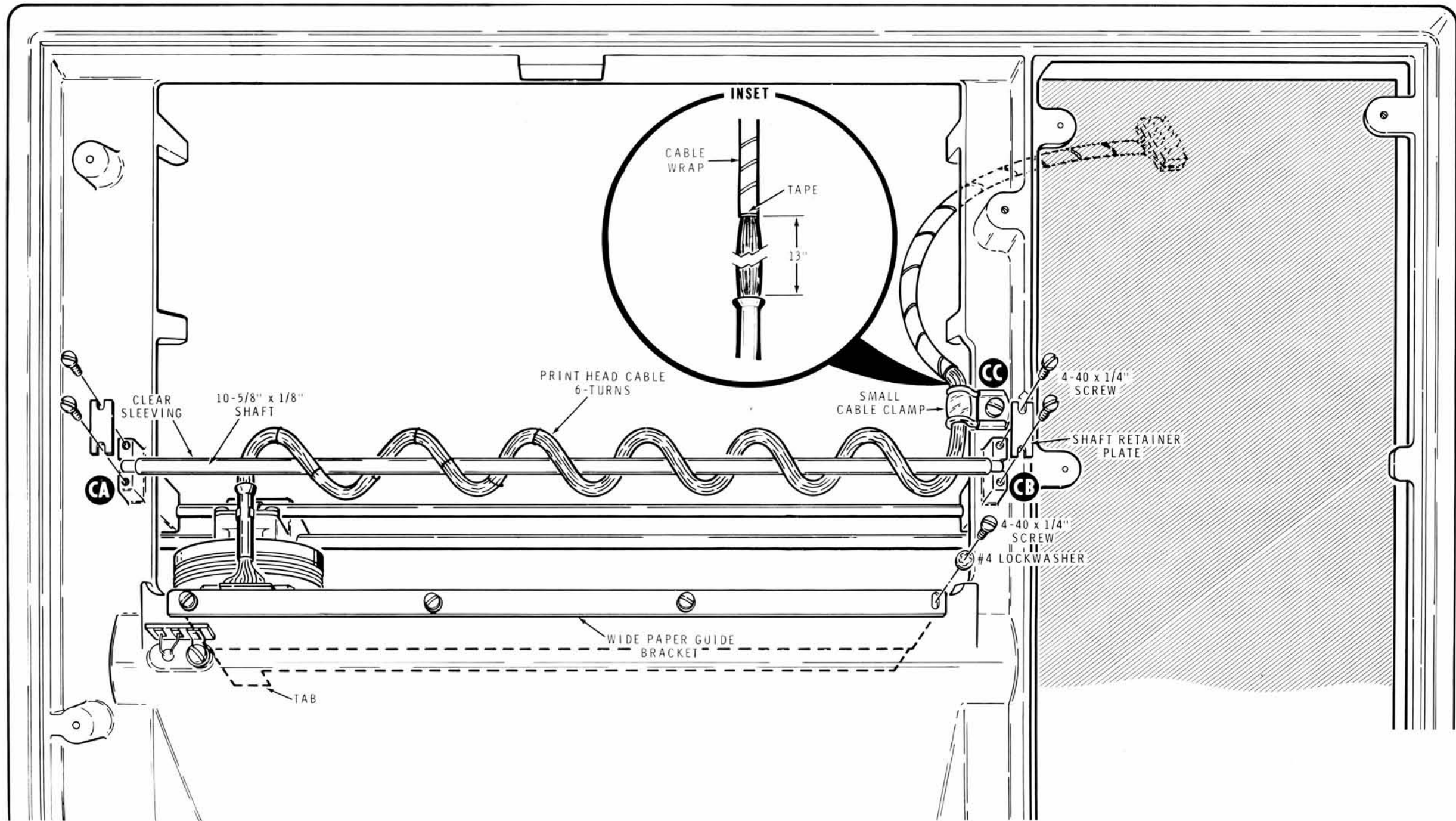

PICTORIAL 4-10

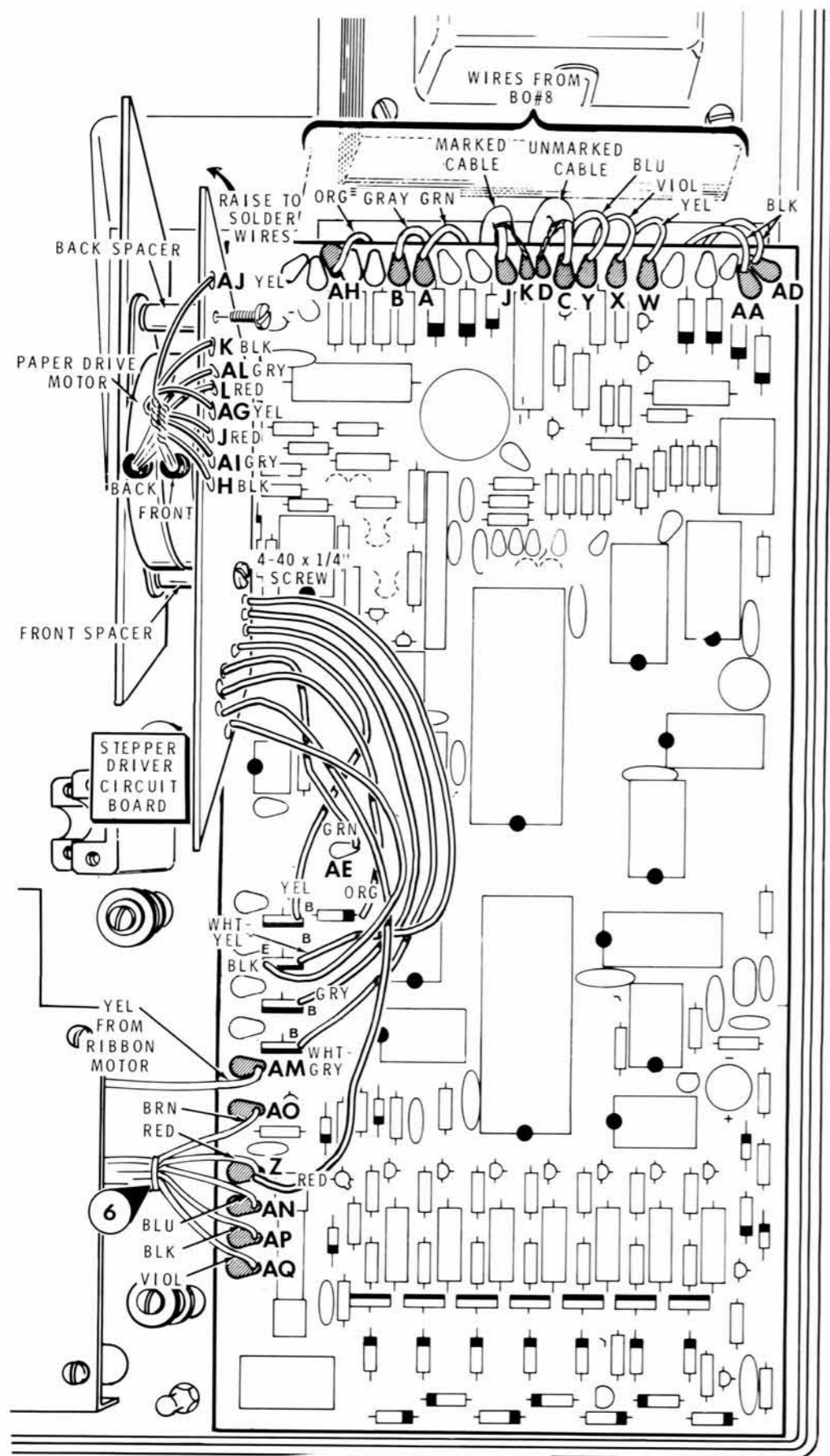

PICTORIAL 5-1

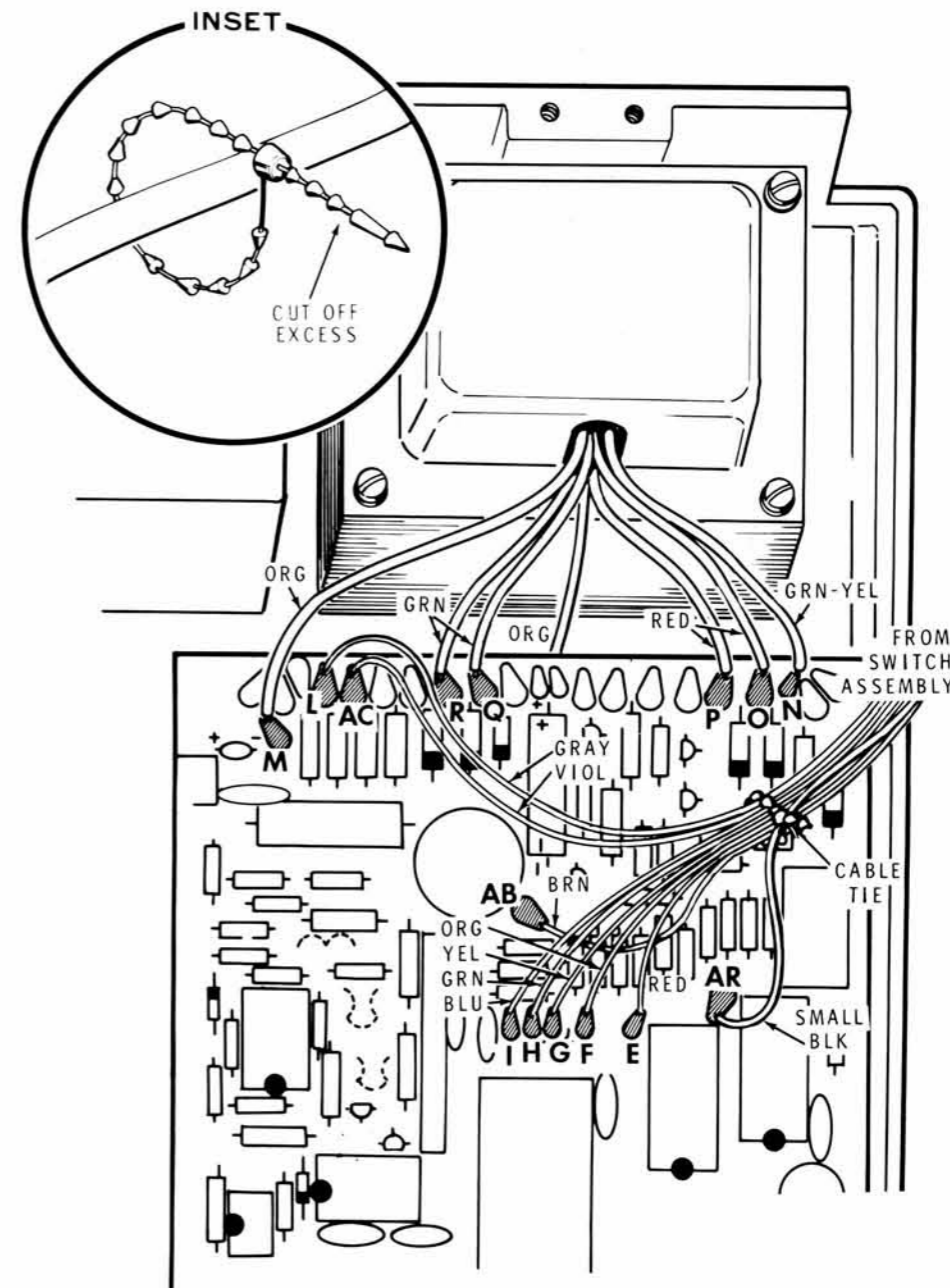

PICTORIAL 5-2

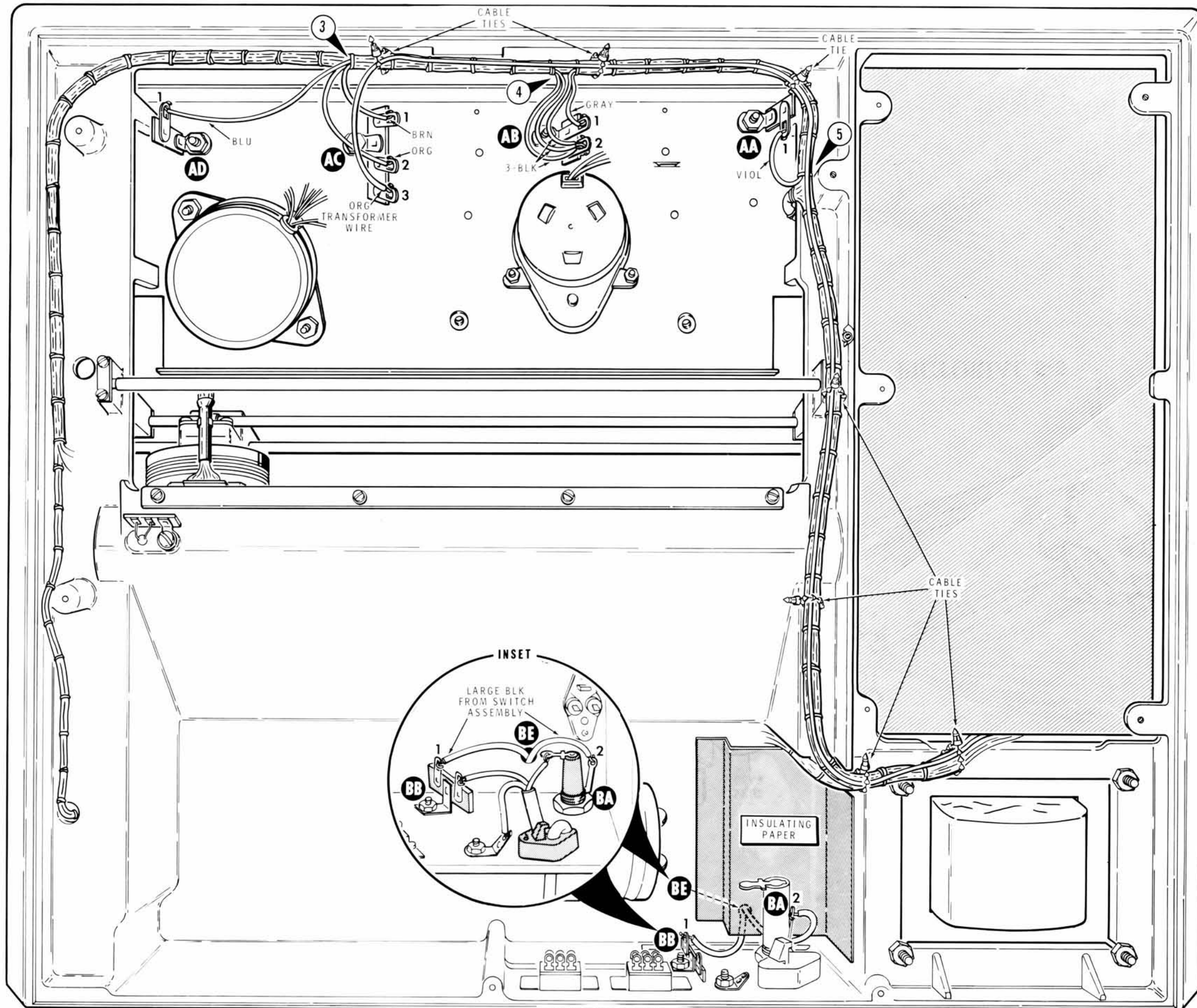

PICTORIAL 5-3

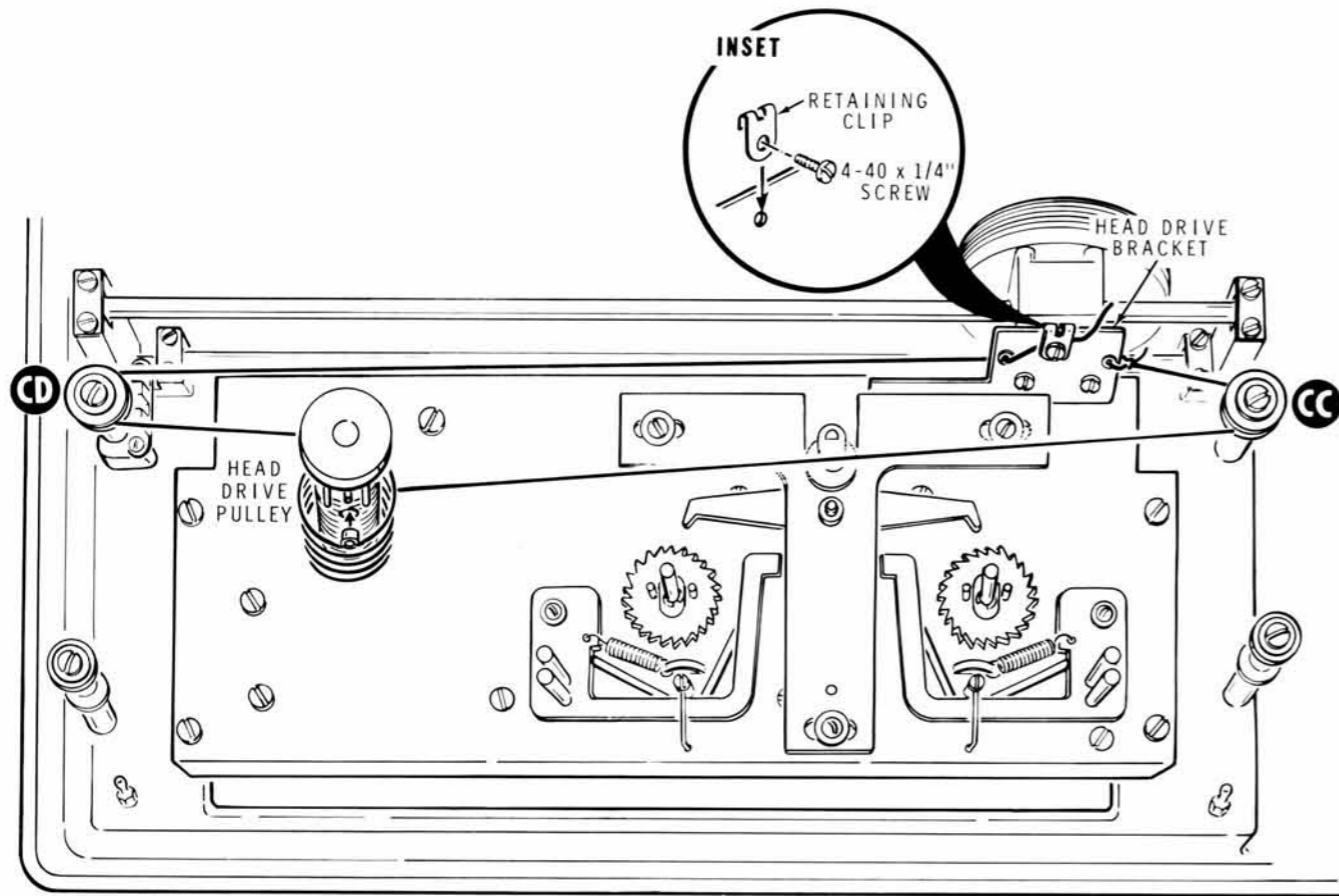

PICTORIAL 5-4

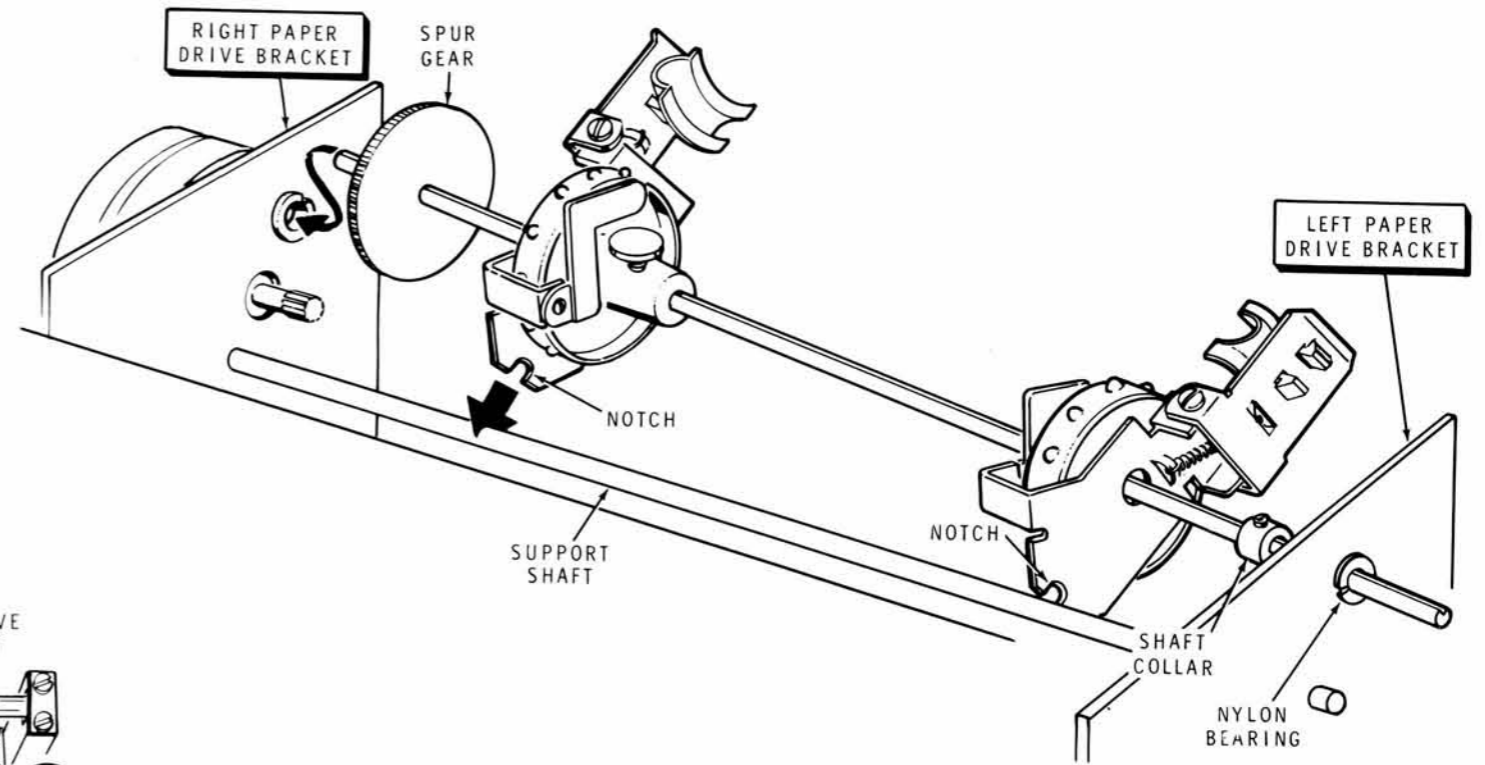

PICTORIAL 5-5



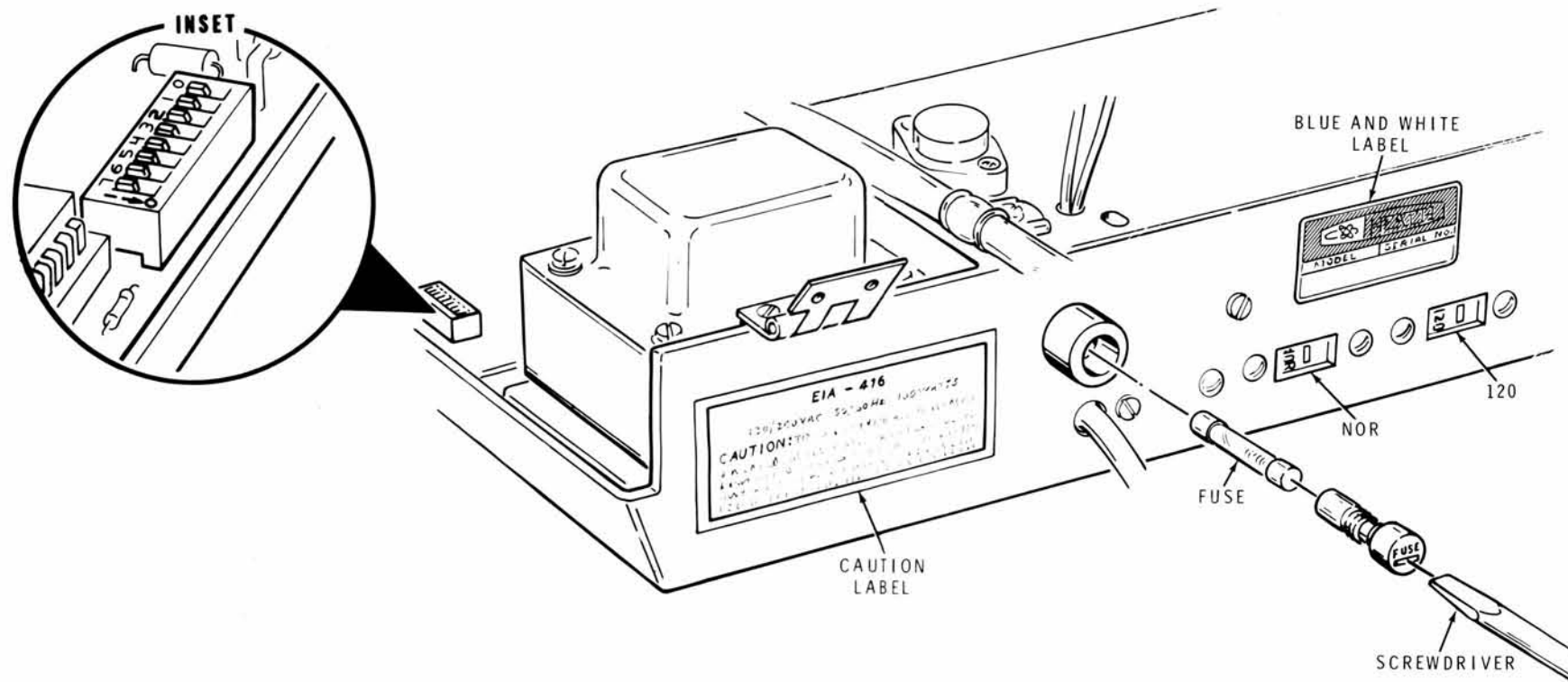

PICTORIAL 5-8

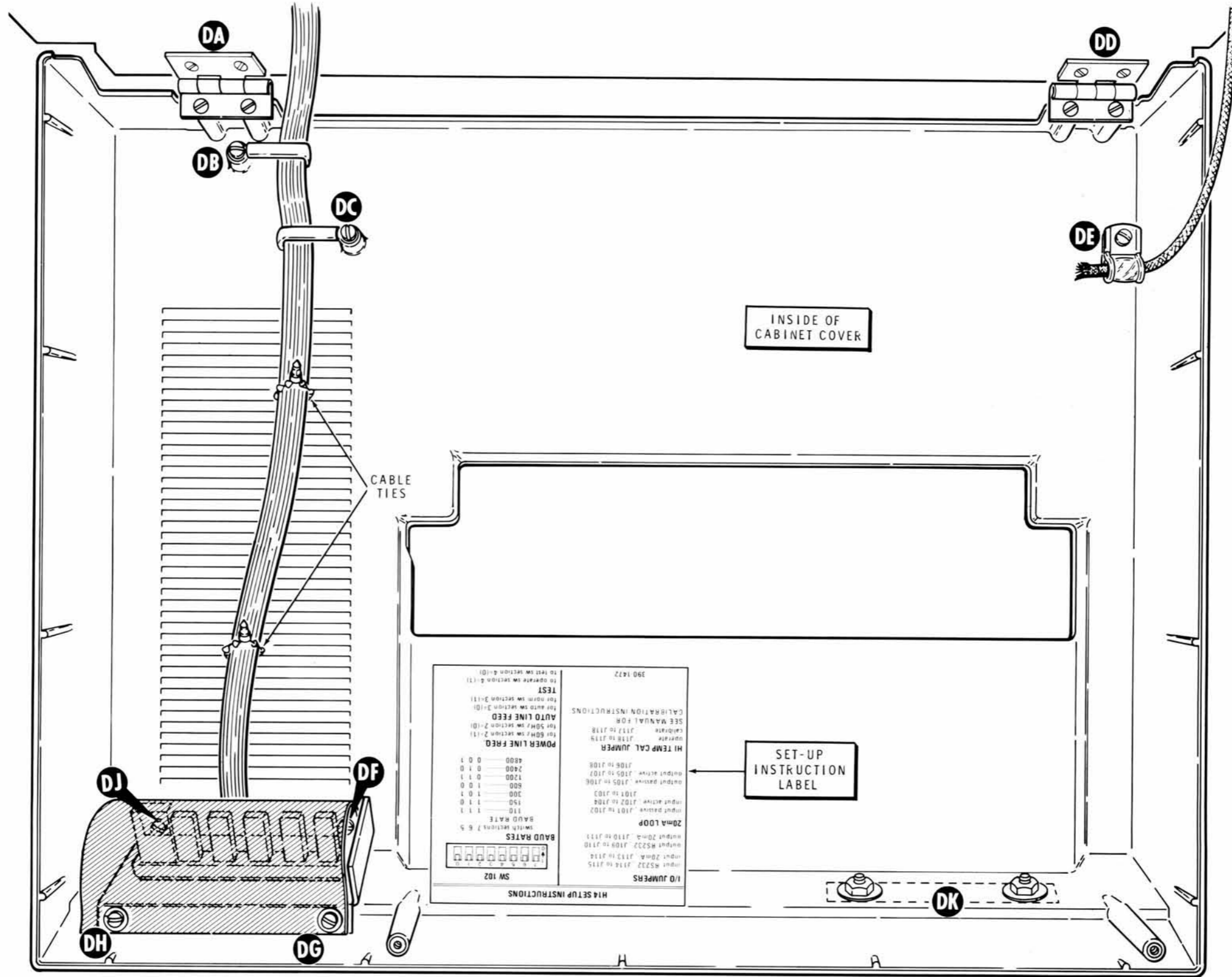

PICTORIAL 5-9

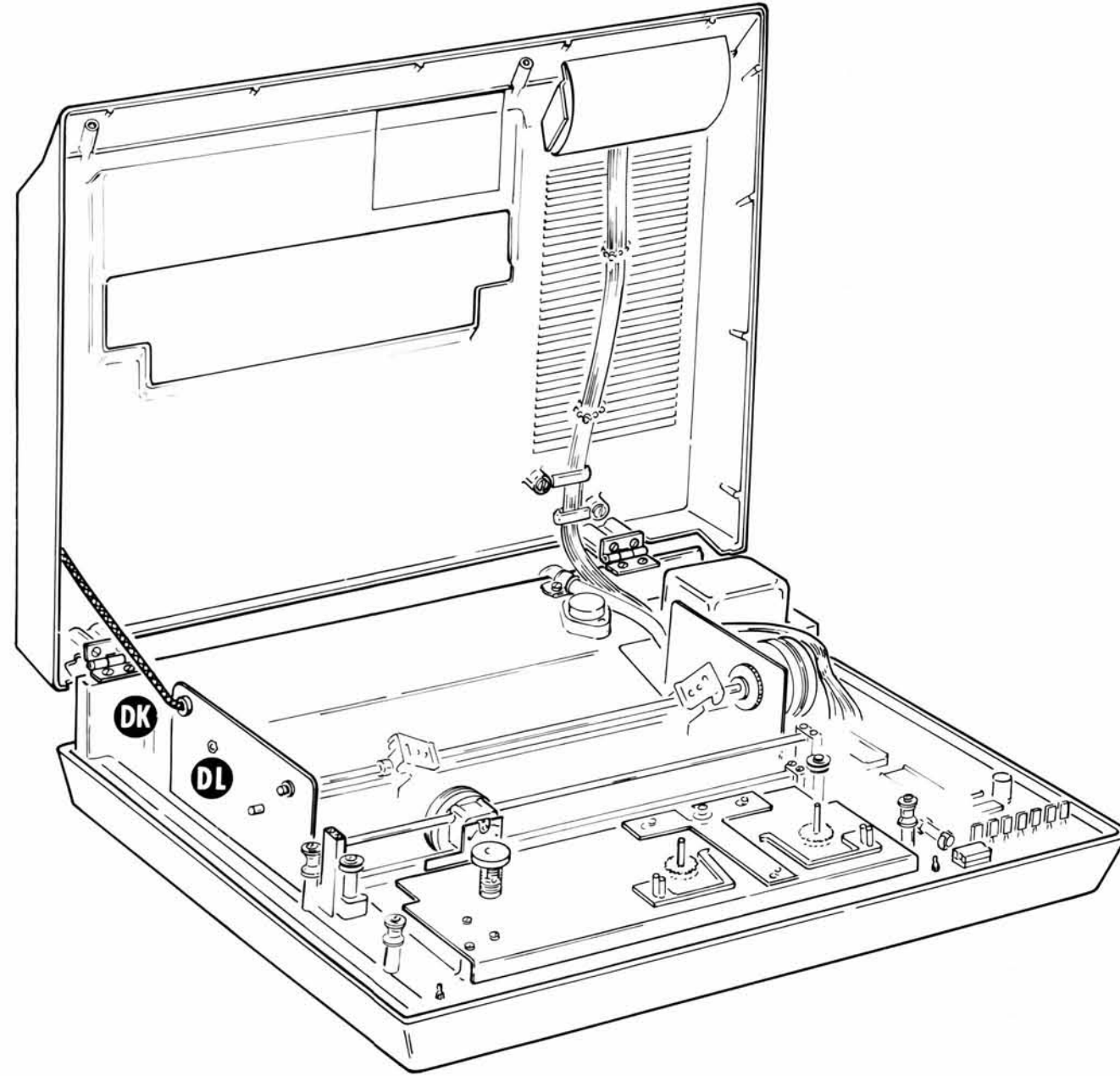
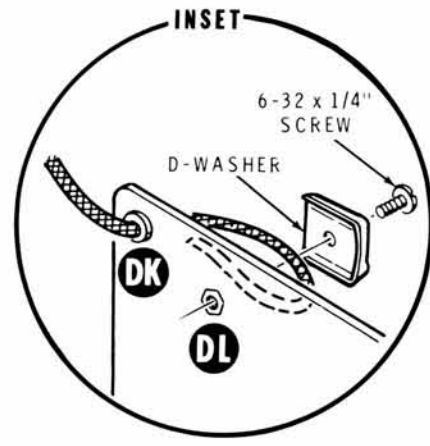

PICTORIAL 5-10

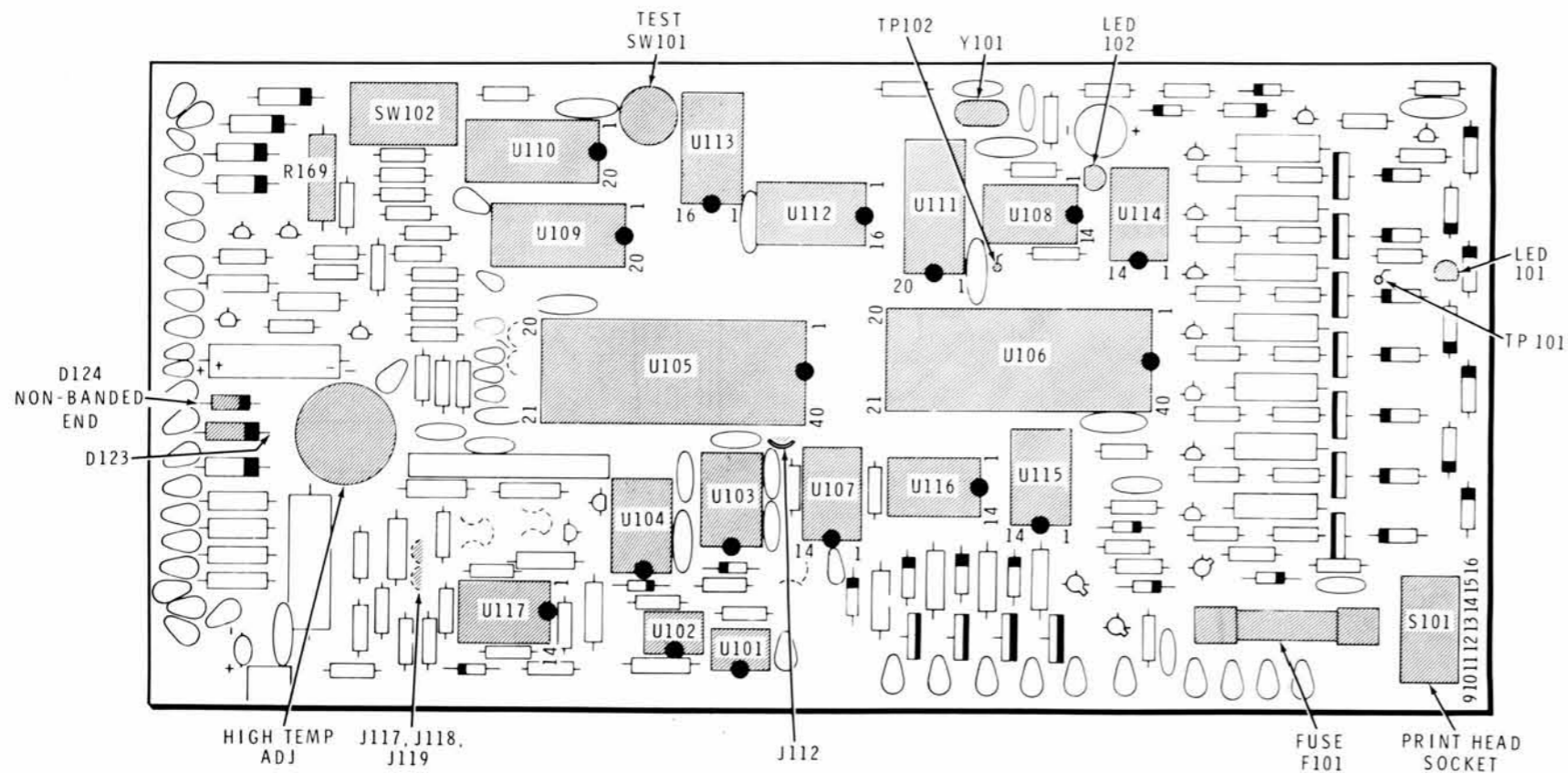

PICTORIAL 6-1

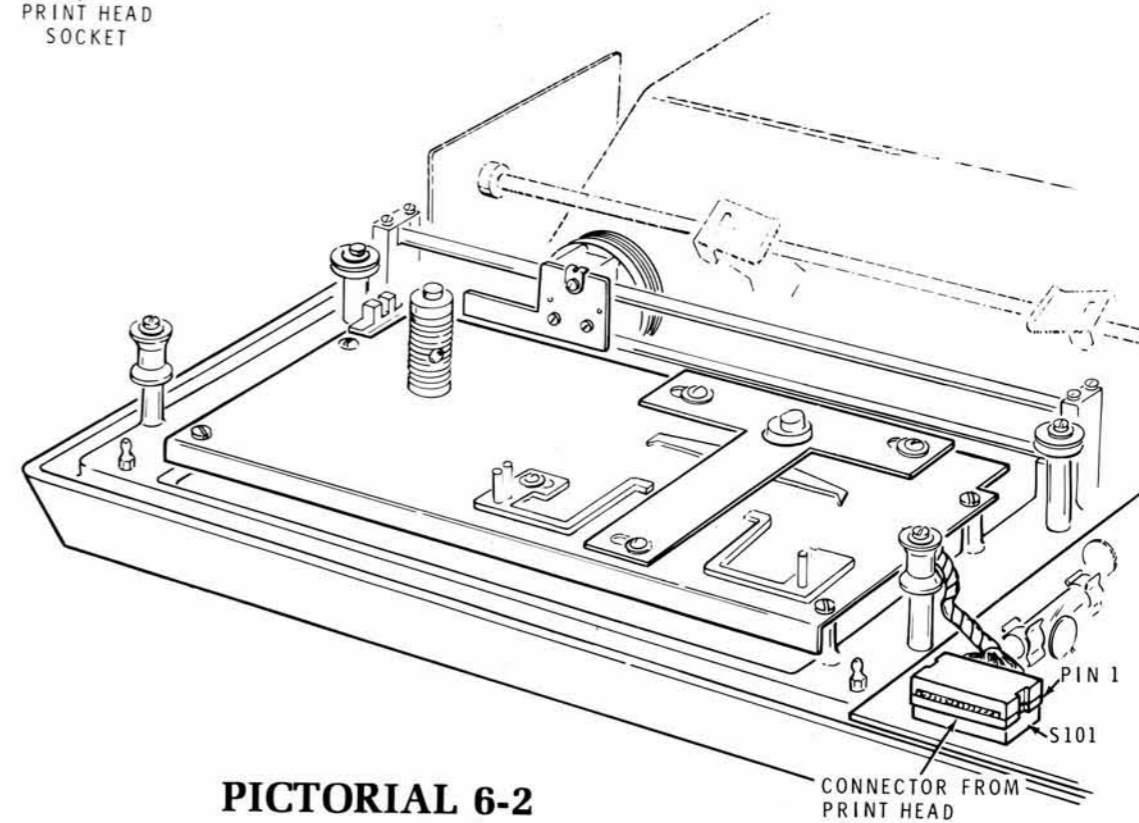

PICTORIAL 6-2

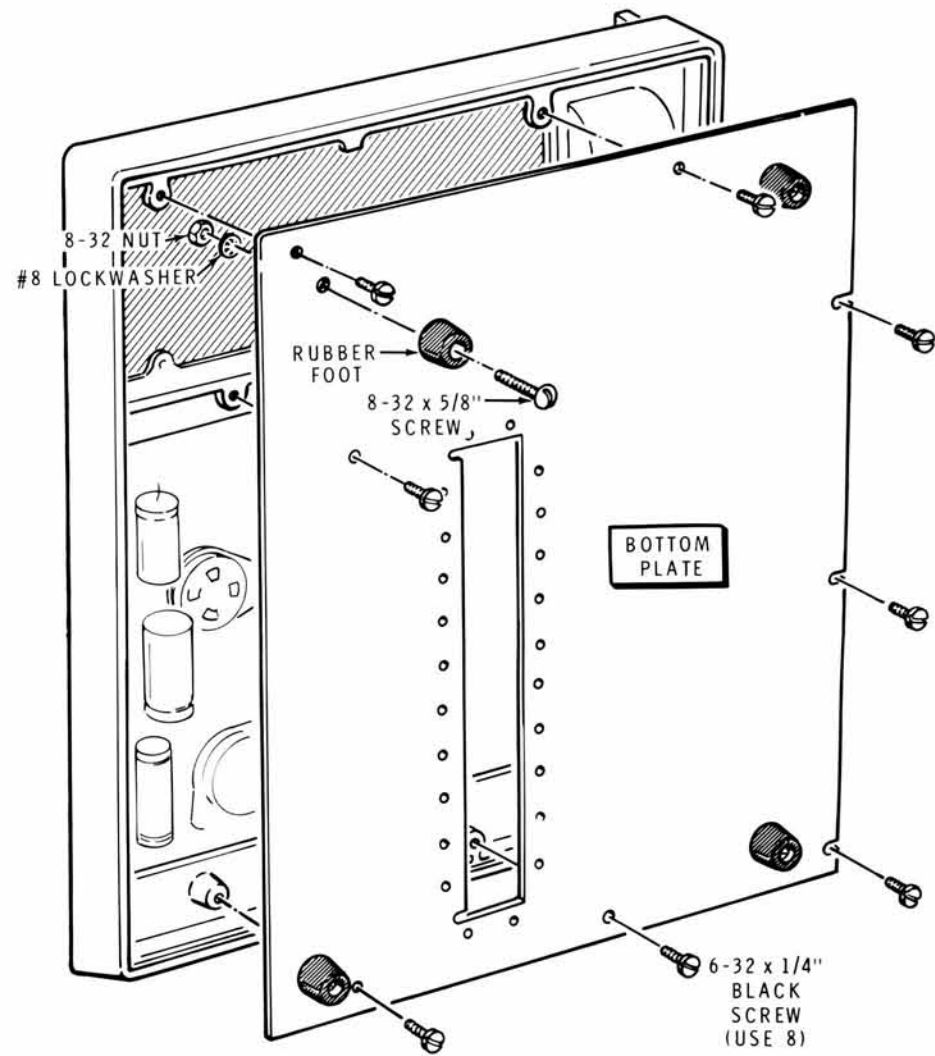

**PICTORIAL 7-1**

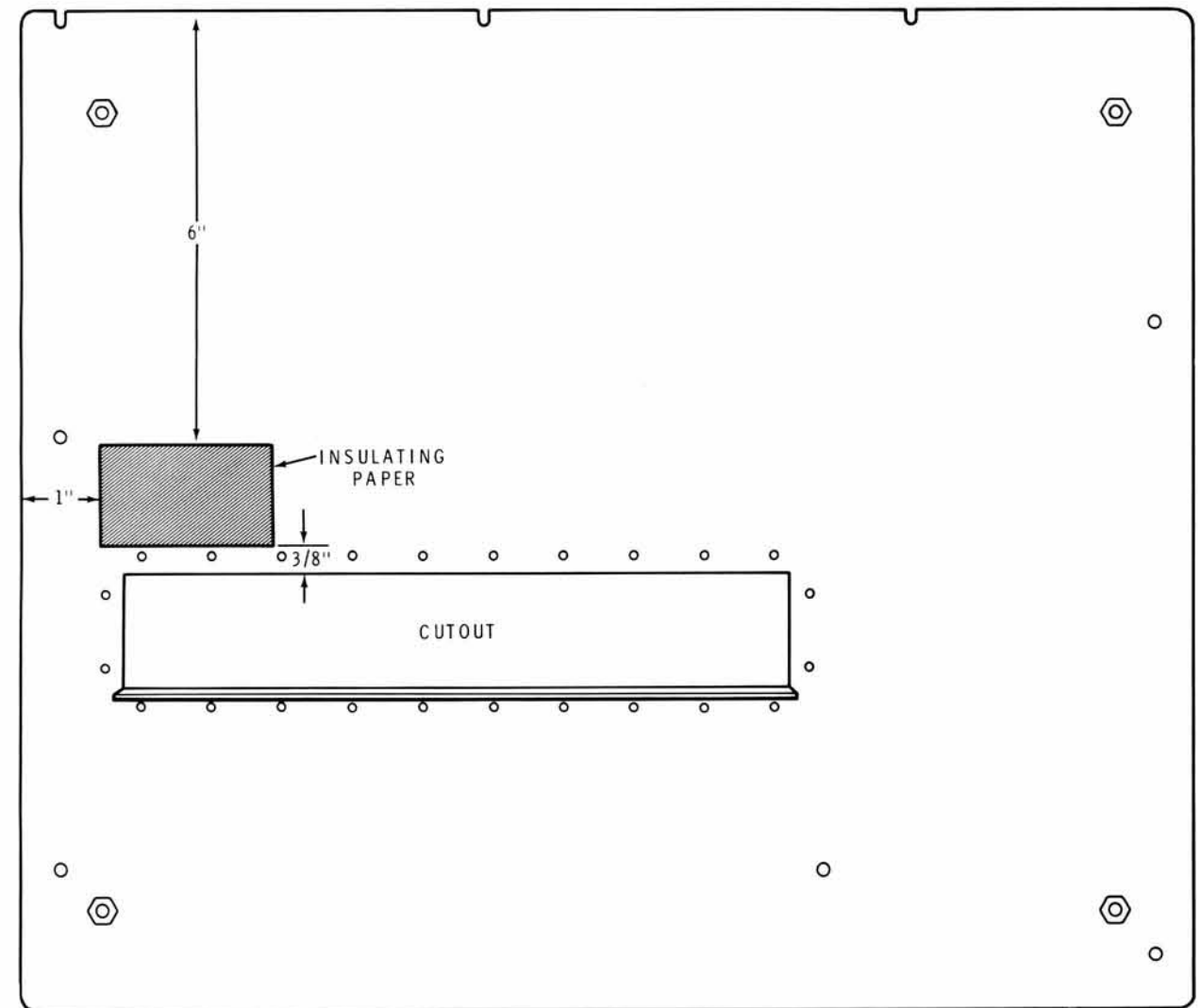

**Detail 7-1A**





